

# Exam Questions SY0-701

CompTIA Security+ Exam

<https://www.2passeasy.com/dumps/SY0-701/>



#### NEW QUESTION 1

- (Exam Topic 1)

Which of the following is a cryptographic concept that operates on a fixed length of bits?

- A. Block cipher
- B. Hashing
- C. Key stretching
- D. Salting

**Answer:** A

#### Explanation:

Single-key or symmetric-key encryption algorithms create a fixed length of bits known as a block cipher with a secret key that the creator/sender uses to encipher data (encryption) and the receiver uses to decipher it.

#### NEW QUESTION 2

- (Exam Topic 1)

A store receives reports that shoppers' credit card information is being stolen. Upon further analysis, those same shoppers also withdrew money from an ATM in that store.

The attackers are using the targeted shoppers' credit card information to make online purchases. Which of the following attacks is the MOST probable cause?

- A. Identity theft
- B. RFID cloning
- C. Shoulder surfing
- D. Card skimming

**Answer:** D

#### Explanation:

The attackers are using card skimming to steal shoppers' credit card information, which they use to make online purchases. References:

➤ [CompTIA Security+ Study Guide Exam SY0-601, Chapter 5](#)

#### NEW QUESTION 3

- (Exam Topic 1)

A retail company that is launching @ new website to showcase the company's product line and other information for online shoppers registered the following URLs:

- \* www.companysite.com
- \* shop.companysite.com
- \* about-us.companysite.com
- \* contact-us.companysite.com
- \* secure-logon.companysite.com

Which of the following should the company use to secure its website if the company is concerned with convenience and cost?

- A. A self-signed certificate
- B. A root certificate
- C. A code-signing certificate
- D. A wildcard certificate
- E. An extended validation certificate

**Answer:** D

#### Explanation:

The company can use a wildcard certificate to secure its website if it is concerned with convenience and cost. A wildcard certificate can secure multiple subdomains, which makes it cost-effective and convenient for securing the various registered domains.

The retail company should use a wildcard certificate if it is concerned with convenience and cost. A wildcard SSL certificate is a single SSL/TLS certificate that can provide significant time and cost savings, particularly for small businesses. The certificate includes a wildcard character (\*) in the domain name field, and can secure multiple subdomains of the primary domain.

#### NEW QUESTION 4

- (Exam Topic 1)

A company wants to modify its current backup strategy to minimize the number of backups that would need to be restored in case of data loss. Which of the following would be the BEST backup strategy?

- A. Incremental backups followed by differential backups
- B. Full backups followed by incremental backups
- C. Delta backups followed by differential backups
- D. Incremental backups followed by delta backups
- E. Full backup followed by differential backups

**Answer:** B

#### Explanation:

The best backup strategy for minimizing the number of backups that need to be restored in case of data loss is full backups followed by incremental backups. This strategy allows for a complete restoration of data by restoring the most recent full backup followed by the most recent incremental backup. Reference: CompTIA Security+ Certification Guide, Third Edition (Exam SY0-601) page 126

#### NEW QUESTION 5

- (Exam Topic 1)

The Chief information Security Officer has directed the security and networking team to retire the use of shared passwords on routers and switches. Which of the following choices BEST meets the requirements?

- A. SAML
- B. TACACS+
- C. Password vaults
- D. OAuth

**Answer:** B

**Explanation:**

TACACS+ is a protocol used for remote authentication, authorization, and accounting (AAA) that can be used to replace shared passwords on routers and switches. It provides a more secure method of authentication that allows for centralized management of access control policies. References: CompTIA Security+ Study Guide, Exam SY0-601, 4th Edition, Chapter 6

**NEW QUESTION 6**

- (Exam Topic 1)

A Chief Information Officer is concerned about employees using company-issued laptops to steal data when accessing network shares. Which of the following should the company implement?

- A. DLP
- B. CASB
- C. HIDS
- D. EDR
- E. UEFI

**Answer:** A

**Explanation:**

The company should implement Data Loss Prevention (DLP) to prevent employees from stealing data when accessing network shares. References:

➤ CompTIA Security+ Study Guide Exam SY0-601, Chapter 8

**NEW QUESTION 7**

- (Exam Topic 1)

Developers are writing code and merging it into shared repositories several times a day, where it is tested automatically. Which of the following concepts does this BEST represent?

- A. Functional testing
- B. Stored procedures
- C. Elasticity
- D. Continuous integration

**Answer:** D

**Explanation:**

Continuous integration is a software development practice where developers merge their code into a shared repository several times a day, and the code is tested automatically. This ensures that code changes are tested and integrated continuously, reducing the risk of errors and conflicts.

**NEW QUESTION 8**

- (Exam Topic 1)

The Chief Executive Officer announced a new partnership with a strategic vendor and asked the Chief Information Security Officer to federate user digital identities using SAML-based protocols. Which of the following will this enable?

- A. SSO
- B. MFA
- C. PKI
- D. OLP

**Answer:** A

**Explanation:**

Federating user digital identities using SAML-based protocols enables Single Sign-On (SSO), which allows users to log in once and access multiple applications without having to enter their credentials for each one. References:

➤ CompTIA Security+ Certification Exam Objectives 1.3: Explain authentication and access controls.

➤ CompTIA Security+ Study Guide, Sixth Edition, pages 41-42

**NEW QUESTION 9**

- (Exam Topic 1)

A company reduced the area utilized in its datacenter by creating virtual networking through automation and by creating provisioning routes and rules through scripting. Which of the following does this example describe?

- A. IaC
- B. MSSP
- C. Containers
- D. SaaS

**Answer:** A

**Explanation:**

IaaS (Infrastructure as a Service) allows the creation of virtual networks, automation, and scripting to reduce the area utilized in a datacenter. References: CompTIA Security+ Study Guide, Exam SY0-601, Chapter 4

**NEW QUESTION 10**

- (Exam Topic 1)

A security analyst was deploying a new website and found a connection attempting to authenticate on the site's portal. While Investigating The incident, the analyst identified the following Input in the username field:

```
admin' or 1=1--
```

Which of the following BEST explains this type of attack?

- A. DLL injection to hijack administrator services
- B. SQLi on the field to bypass authentication
- C. Execution of a stored XSS on the website
- D. Code to execute a race condition on the server

**Answer:** B

**Explanation:**

The input "admin' or 1=1--" in the username field is an example of SQL injection (SQLi) attack. In this case, the attacker is attempting to bypass authentication by injecting SQL code into the username field that will cause the authentication check to always return true. References: CompTIA Security+ SY0-601 Exam Objectives: 3.1 Given a scenario, use appropriate software tools to assess the security posture of an organization.

**NEW QUESTION 10**

- (Exam Topic 1)

A company acquired several other small companies The company that acquired the others is transitioning network services to the cloud The company wants to make sure that performance and security remain intact Which of the following BEST meets both requirements?

- A. High availability
- B. Application security
- C. Segmentation
- D. Integration and auditing

**Answer:** A

**Explanation:**

High availability refers to the ability of a system or service to remain operational and available to users with minimal downtime. By ensuring high availability, the company can maintain good performance and ensure that users have access to the network services they need. High availability can also improve security, as it helps to prevent disruptions that could potentially be caused by security incidents or other issues.

**NEW QUESTION 15**

- (Exam Topic 1)

A company installed several crosscut shredders as part of increased information security practices targeting data leakage risks. Which of the following will this practice reduce?

- A. Dumpster diving
- B. Shoulder surfing
- C. Information elicitation
- D. Credential harvesting

**Answer:** A

**Explanation:**

Crosscut shredders are used to destroy paper documents and reduce the risk of data leakage through dumpster diving. Dumpster diving is a method of retrieving sensitive information from paper waste by searching through discarded documents.

References:

➤ CompTIA Security+ Study Guide, Exam SY0-601, 4th Edition, Chapter 2

**NEW QUESTION 16**

- (Exam Topic 1)

The Chief Information Security Officer wants to pilot a new adaptive, user-based authentication method. The concept Includes granting logical access based on physical location and proximity. Which of the following Is the BEST solution for the pilot?

- A. Geofencing
- B. Self-sovereign identification
- C. PKI certificates
- D. SSO

**Answer:** A

**Explanation:**

Geofencing is a location-based technology that allows an organization to define and enforce logical access control policies based on physical location and proximity. Geofencing can be used to grant or restrict access to systems, data, or facilities based on an individual's location, and it can be integrated into a user's device or the infrastructure. This makes it a suitable solution for the pilot project to test the adaptive, user-based authentication method that includes granting logical access based on physical location and proximity.

Reference: CompTIA Security+ SY0-601 Official Text Book, Chapter 4: "Identity and Access Management".

#### NEW QUESTION 21

- (Exam Topic 1)

An information security manager for an organization is completing a PCI DSS self-assessment for the first time. which of the is following MOST likely reason for this type of assessment?

- A. An international expansion project is currently underway.
- B. Outside consultants utilize this tool to measure security maturity.
- C. The organization is expecting to process credit card information.
- D. A government regulator has requested this audit to be completed

**Answer:** C

#### Explanation:

PCI DSS (Payment Card Industry Data Security Standard) is a set of security standards designed to ensure that all companies that accept, process, store, or transmit credit card information maintain a secure environment. Any organization that accepts credit card payments is required to comply with PCI DSS.

#### NEW QUESTION 24

- (Exam Topic 1)

Which of the following environments typically hosts the current version configurations and code, compares user-story responses and workflow, and uses a modified version of actual data for testing?

- A. Development
- B. Staging
- C. Production
- D. Test

**Answer:** B

#### Explanation:

Staging is an environment in the software development lifecycle that is used to test a modified version of the actual data, current version configurations, and code. This environment compares user-story responses and workflow before the software is released to the production environment. References: CompTIA Security+ Study Guide, Sixth Edition, Sybex, pg. 496

#### NEW QUESTION 28

- (Exam Topic 1)

During a forensic investigation, a security analyst discovered that the following command was run on a compromised host:

```
crackmapexec smb 192.168.10.232 -u localadmin -H 0A3CE8D07A46E5C51070F03593E0A5E6
```

Which of the following attacks occurred?

- A. Buffer overflow
- B. Pass the hash
- C. SQL injection
- D. Replay attack

**Answer:** B

#### Explanation:

Pass the hash is an attack technique that allows an attacker to authenticate to a remote server or service by using the hashed version of a user's password, rather than requiring the plaintext password

#### NEW QUESTION 31

- (Exam Topic 1)

After a hardware incident, an unplanned emergency maintenance activity was conducted to rectify the issue. Multiple alerts were generated on the SIEM during this period of time. Which of the following BEST explains what happened?

- A. The unexpected traffic correlated against multiple rules, generating multiple alerts.
- B. Multiple alerts were generated due to an attack occurring at the same time.
- C. An error in the correlation rules triggered multiple alerts.
- D. The SIEM was unable to correlate the rules, triggering the alert

**Answer:** A

#### Explanation:

Multiple alerts were generated on the SIEM during the emergency maintenance activity due to unexpected traffic correlated against multiple rules. The SIEM generates alerts when it detects an event that matches a rule in its rulebase. If the event matches multiple rules, the SIEM will generate multiple alerts. Reference: CompTIA Security+ Study Guide, Exam SY0-601, Chapter 3: Architecture and Design

#### NEW QUESTION 35

- (Exam Topic 1)

Which of the following BEST describes the team that acts as a referee during a penetration-testing exercise?

- A. White team
- B. Purple team
- C. Green team
- D. Blue team
- E. Red team

**Answer:** A



**Explanation:**

During a penetration testing exercise, the white team is responsible for acting as a referee and providing oversight and support to ensure that the testing is conducted safely and effectively. They may also be responsible for determining the rules and guidelines of the exercise, monitoring the progress of the teams, and providing feedback and insights on the strengths and weaknesses of the organization's security measures.

**NEW QUESTION 38**

- (Exam Topic 1)

Which of the following is a risk that is specifically associated with hosting applications in the public cloud?

- A. Unsecured root accounts
- B. Zero day
- C. Shared tenancy
- D. Insider threat

**Answer:** C

**Explanation:**

When hosting applications in the public cloud, there is a risk of shared tenancy, meaning that multiple organizations are sharing the same infrastructure. This can potentially allow one tenant to access another tenant's data, creating a security risk. References: CompTIA Security+ Certification Exam Objectives (SY0-601)

**NEW QUESTION 42**

- (Exam Topic 1)

Which of the technologies is used to actively monitor for specific file types being transmitted on the network?

- A. File integrity monitoring
- B. Honeynets
- C. Tcpreplay
- D. Data loss prevention

**Answer:** D

**Explanation:**

Data loss prevention (DLP) is a technology used to actively monitor for specific file types being transmitted on the network. DLP solutions can prevent the unauthorized transfer of sensitive information, such as credit card numbers and social security numbers, by monitoring data in motion.

References: CompTIA Security+ Study Guide, Exam SY0-601, 4th Edition, Chapter 2: Technologies and Tools, pp. 99-102.

**NEW QUESTION 47**

- (Exam Topic 1)

A security analyst must enforce policies to harden an MDM infrastructure. The requirements are as follows:

- \* Ensure mobile devices can be tracked and wiped.
- \* Confirm mobile devices are encrypted.

Which of the following should the analyst enable on all the devices to meet these requirements?

- A. A Geofencing
- B. Biometric authentication
- C. Geolocation
- D. Geotagging

**Answer:** A

**Explanation:**

Geofencing is a technology used in mobile device management (MDM) to allow administrators to define geographical boundaries within which mobile devices can operate. This can be used to enforce location-based policies, such as ensuring that devices can be tracked and wiped if lost or stolen. Additionally, encryption can be enforced on the devices to ensure the protection of sensitive data in the event of theft or loss. References:

➤ CompTIA Security+ Study Guide, Exam SY0-601, 4th Edition, Chapter 7

**NEW QUESTION 51**

- (Exam Topic 1)

A desktop support technician recently installed a new document-scanning software program on a computer. However, when the end user tried to launch the program, it did not respond. Which of the following is MOST likely the cause?

- A. A new firewall rule is needed to access the application.
- B. The system was quarantined for missing software updates.
- C. The software was not added to the application whitelist.
- D. The system was isolated from the network due to infected software

**Answer:** C

**Explanation:**

The most likely cause of the document-scanning software program not responding when launched by the end user is that the software was not added to the application whitelist. An application whitelist is a list of approved software applications that are allowed to run on a system. If the software is not on the whitelist, it may be blocked from running by the system's security policies. Adding the software to the whitelist should resolve the issue and allow the program to run.

References: <https://www.techopedia.com/definition/31541/application-whitelisting>

**NEW QUESTION 52**

- (Exam Topic 1)

Which of the following biometric authentication methods is the MOST accurate?

- A. Gait
- B. Retina
- C. Signature
- D. Voice

**Answer:** B

**Explanation:**

Retina authentication is the most accurate biometric authentication method. Retina authentication is based on recognizing the unique pattern of blood vessels and other features in the retina. This makes it virtually impossible to duplicate or bypass, making it the most secure form of biometric authentication currently available.

**NEW QUESTION 53**

- (Exam Topic 1)

A security analyst is investigating multiple hosts that are communicating to external IP addresses during the hours of 2:00 a.m - 4:00 am. The malware has evaded detection by traditional antivirus software. Which of the following types of malware is MOST likely infecting the hosts?

- A. A RAT
- B. Ransomware
- C. Polymorphic
- D. A worm

**Answer:** A

**Explanation:**

Based on the given information, the most likely type of malware infecting the hosts is a RAT (Remote Access Trojan). RATs are often used for stealthy unauthorized access to a victim's computer, and they can evade traditional antivirus software through various sophisticated techniques. In particular, the fact that the malware is communicating with external IP addresses during specific hours suggests that it may be under the control of an attacker who is issuing commands from a remote location. Ransomware, polymorphic malware, and worms are also possible culprits, but the context of the question suggests that a RAT is the most likely answer.

**NEW QUESTION 54**

- (Exam Topic 1)

A security researcher is tracking an adversary by noting its attacks and techniques based on its capabilities, infrastructure, and victims. Which of the following is the researcher MOST likely using?

- A. The Diamond Model of Intrusion Analysis
- B. The Cyber Kill Chain
- C. The MITRE CVE database
- D. The incident response process

**Answer:** A

**Explanation:**

The Diamond Model is a framework for analyzing cyber threats that focuses on four key elements: adversary, capability, infrastructure, and victim. By analyzing these elements, security researchers can gain a better understanding of the threat landscape and develop more effective security strategies.

**NEW QUESTION 58**

- (Exam Topic 1)

A company has discovered unauthorized devices are using its WiFi network, and it wants to harden the access point to improve security. Which of the following configuration should an analysis enable To improve security? (Select TWO.)

- A. RADIUS
- B. PEAP
- C. WPS
- D. WEP-EKIP
- E. SSL
- F. WPA2-PSK

**Answer:** AF

**Explanation:**

To improve the security of the WiFi network and prevent unauthorized devices from accessing the network, the configuration options of RADIUS and WPA2-PSK should be enabled. RADIUS (Remote Authentication Dial-In User Service) is an authentication protocol that can be used to control access to the WiFi network. It can provide stronger authentication and authorization than WEP and WPA. WPA2-PSK (WiFi Protected Access 2 with Pre-Shared Key) is a security protocol that uses stronger encryption than WEP and WPA. It requires a pre-shared key (PSK) to be entered on each device that wants to access the network. This helps prevent unauthorized devices from accessing the network.

**NEW QUESTION 60**

- (Exam Topic 1)

A security analyst wants to verify that a client-server (non-web) application is sending encrypted traffic. Which of the following should the analyst use?

- A. openssl
- B. hping
- C. netcat
- D. tcpdump

**Answer:** A

**Explanation:**

To verify that a client-server (non-web) application is sending encrypted traffic, a security analyst can use OpenSSL. OpenSSL is a software library that provides cryptographic functions, including encryption and decryption, in support of various security protocols, including SSL/TLS. It can be used to check whether a client-server application is using encryption to protect traffic. References:

➤ CompTIA Security+ Certification Exam Objectives - Exam SY0-601

**NEW QUESTION 65**

- (Exam Topic 1)

Which of the following cryptographic concepts would a security engineer utilize while implementing non-repudiation? (Select TWO)

- A. Block cipher
- B. Hashing
- C. Private key
- D. Perfect forward secrecy
- E. Salting
- F. Symmetric keys

**Answer:** BC

**Explanation:**

Non-repudiation is the ability to ensure that a party cannot deny a previous action or event. Cryptographic concepts that can be used to implement non-repudiation include hashing and digital signatures, which use a private key to sign a message and ensure that the signature is unique to the signer. References: CompTIA Security+ Certification Exam Objectives (SY0-601)

**NEW QUESTION 66**

- (Exam Topic 1)

Which of the following identifies the point in time when an organization will recover data in the event of an outage?

- A. SLA
- B. RPO
- C. MTBF
- D. ARO

**Answer:** B

**Explanation:**

Detailed

Recovery Point Objective (RPO) is the maximum duration of time that an organization can tolerate data loss in the event of an outage. It identifies the point in time when data recovery must begin, and any data loss beyond that point is considered unacceptable.

Reference: CompTIA Security+ Certification Guide, Exam SY0-601 by Mike Chapple and David Seidl, Chapter-7: Incident Response and Recovery, Objective 7.2: Compare and contrast business continuity and disaster recovery concepts, pp. 349-350.

**NEW QUESTION 67**

- (Exam Topic 1)

A grocery store is expressing security and reliability concerns regarding the on-site backup strategy currently being performed by locally attached disks. The main concerns are the physical security of the backup media and the durability of the data stored on these devices Which of the following is a cost-effective approach to address these concerns?

- A. Enhance resiliency by adding a hardware RAID.
- B. Move data to a tape library and store the tapes off-site
- C. Install a local network-attached storage.
- D. Migrate to a cloud backup solution

**Answer:** D

**Explanation:**

a backup strategy is a plan that defines how to protect data from loss or corruption by creating and storing copies of data on a different medium or location<sup>1</sup>. A backup strategy should consider the security and reliability of the backup data and the backup storage<sup>234</sup>.

Based on these definitions, the best option that is a cost-effective approach to address the security and reliability concerns regarding the on-site backup strategy would be D. Migrate to a cloud backup solution<sup>2n4</sup>. A cloud backup solution can provide several benefits, such as:

- Enhanced physical security of the backup data by storing it in a remote location that is protected by multiple layers of security measures.
- Enhanced durability of the backup data by storing it on highly reliable storage devices that are replicated across multiple availability zones or regions.
- Reduced costs of backup storage by paying only for the amount of data stored and transferred, and by using features such as compression, deduplication, encryption, and lifecycle management.
- Increased flexibility and scalability of backup storage by choosing from various storage classes and tiers that match the performance and availability requirements of the backup data.

**NEW QUESTION 69**

- (Exam Topic 1)

A security architect is implementing a new email architecture for a company. Due to security concerns, the Chief Information Security Officer would like the new architecture to support email encryption, as well as provide for digital signatures. Which of the following should the architect implement?

- A. TOP
- B. IMAP
- C. HTTPS
- D. S/MIME



**Answer:** D

**Explanation:**

S/MIME (Secure/Multipurpose Internet Mail Extensions) is a protocol that enables secure email messages to be sent and received. It provides email encryption, as well as digital signatures, which can be used to verify the authenticity of the sender. S/MIME can be used with a variety of email protocols, including POP and IMAP.

References:

- <https://www.comptia.org/content/guides/what-is-smime>
- CompTIA Security+ Study Guide, Sixth Edition (SY0-601), page 139

**NEW QUESTION 74**

- (Exam Topic 1)

Which of the following is required in order for an IDS and a WAF to be effective on HTTPS traffic?

- A. Hashing
- B. DNS sinkhole
- C. TLS inspection
- D. Data masking

**Answer:** C

**Explanation:**

an IDS (Intrusion Detection System) and a WAF (Web Application Firewall) are both used to monitor and protect web applications from common attacks such as cross-site scripting and SQL injection<sup>12</sup>. However, these attacks can also be hidden in encrypted HTTPS traffic, which uses the TLS (Transport Layer Security) protocol to provide cryptography and authentication between two communicating applications<sup>34</sup>. Therefore, in order for an IDS and a WAF to be effective on HTTPS traffic, they need to be able to decrypt and inspect the data that flows in the TLS tunnel. This is achieved by using a feature called TLS inspectio<sup>3n45</sup>, which creates two dedicated TLS connections: one with the web server and another with the client. The firewall then uses a customer-provided CA (Certificate Authority) certificate to generate an on-the-fly certificate that replaces the web server certificate and shares it with the client. This way, the firewall can see the content of the HTTPS traffic and apply the IDS and WAF rules accordingly<sup>34</sup>.

**NEW QUESTION 79**

- (Exam Topic 1)

The security team received a report of copyright infringement from the IP space of the corporate network. The report provided a precise time stamp for the incident as well as the name of the copyrighted files. The analyst has been tasked with determining the infringing source machine and instructed to implement measures to prevent such incidents from occurring again. Which of the following is MOST capable of accomplishing both tasks?

- A. HIDS
- B. Allow list
- C. TPM
- D. NGFW

**Answer:** D

**Explanation:**

Next-Generation Firewalls (NGFWs) are designed to provide advanced threat protection by combining traditional firewall capabilities with intrusion prevention, application control, and other security features. NGFWs can detect and block unauthorized access attempts, malware infections, and other suspicious activity. They can also be used to monitor file access and detect unauthorized copying or distribution of copyrighted material.

A next-generation firewall (NGFW) can be used to detect and prevent copyright infringement by analyzing network traffic and blocking unauthorized transfers of copyrighted material. Additionally, NGFWs can be configured to enforce access control policies that prevent unauthorized access to sensitive resources.

References:

- CompTIA Security+ Study Guide, Exam SY0-601, 4th Edition, Chapter 6

**NEW QUESTION 80**

- (Exam Topic 1)

A global company is experiencing unauthorized logging due to credential theft and account lockouts caused by brute-force attacks. The company is considering implementing a third-party identity provider to help mitigate these attacks. Which of the following would be the BEST control for the company to require from prospective vendors?

- A. IP restrictions
- B. Multifactor authentication
- C. A banned password list
- D. A complex password policy

**Answer:** B

**Explanation:**

Multifactor authentication (MFA) would be the best control to require from a third-party identity provider to help mitigate attacks such as credential theft and brute-force attacks. References: CompTIA Security+ Study Guide, Exam SY0-601, Chapter 2

**NEW QUESTION 85**

- (Exam Topic 1)

A company is required to continue using legacy software to support a critical service. Which of the following BEST explains a risk of this practice?

- A. Default system configuration
- B. Unsecure protocols
- C. Lack of vendor support
- D. Weak encryption

**Answer:** C

**Explanation:**

Using legacy software to support a critical service poses a risk due to lack of vendor support. Legacy software is often outdated and unsupported, which means that security patches and upgrades are no longer available. This can leave the system vulnerable to exploitation by attackers who may exploit known vulnerabilities in the software to gain unauthorized access to the system.

Reference: CompTIA Security+ Study Guide, Exam SY0-601, Chapter 1: Attacks, Threats, and Vulnerabilities

**NEW QUESTION 88**

- (Exam Topic 1)

The help desk has received calls from users in multiple locations who are unable to access core network services. The network team has identified and turned off the network switches using remote commands. Which of the following actions should the network team take NEXT?

- A. Disconnect all external network connections from the firewall
- B. Send response teams to the network switch locations to perform updates
- C. Turn on all the network switches by using the centralized management software
- D. Initiate the organization's incident response plan.

**Answer:** D

**Explanation:**

An incident response plan is a set of procedures and guidelines that defines how an organization should respond to a security incident. An incident response plan typically includes the following phases: preparation, identification, containment, eradication, recovery, and lessons learned.

If the help desk has received calls from users in multiple locations who are unable to access core network services, it could indicate that a network outage or a denial-of-service attack has occurred. The network team has identified and turned off the network switches using remote commands, which could be a containment measure to isolate the affected devices and prevent further damage.

The next action that the network team should take is to initiate the organization's incident response plan, which would involve notifying the appropriate stakeholders, such as management, security team, legal team, etc., and following the predefined steps to investigate, analyze, document, and resolve the incident. The other options are not correct because:

- > A. Disconnect all external network connections from the firewall. This could be another containment measure to prevent external attackers from accessing the network, but it would also disrupt legitimate network traffic and services. This action should be taken only if it is part of the incident response plan and after notifying the relevant parties.
- > B. Send response teams to the network switch locations to perform updates. This could be a recovery measure to restore normal network operations and apply patches or updates to prevent future incidents, but it should be done only after the incident has been properly identified, contained, and eradicated.
- > C. Turn on all the network switches by using the centralized management software. This could be a recovery measure to restore normal network operations, but it should be done only after the incident has been properly identified, contained, and eradicated.

According to CompTIA Security+ SY0-601 Exam Objectives 1.5 Given a scenario, analyze indicators of compromise and determine the type of malware:

“An incident response plan is a set of procedures and guidelines that defines how an organization should respond to a security incident. An incident response plan typically includes the following phases: preparation, identification, containment, eradication, recovery, and lessons learned.”

References: <https://www.comptia.org/certifications/security#examdetails> <https://www.comptia.org/content/guides/comptia-security-sy0-601-exam-objectives>

**NEW QUESTION 91**

- (Exam Topic 1)

A company is required to continue using legacy software to support a critical service. Which of the following BEST explains a risk of this practice?

- A. Default system configuration
- B. Unsecure protocols
- C. Lack of vendor support
- D. Weak encryption

**Answer:** C

**Explanation:**

One of the risks of using legacy software is the lack of vendor support. This means that the vendor may no longer provide security patches, software updates, or technical support for the software. This leaves the software vulnerable to new security threats and vulnerabilities that could be exploited by attackers.

**NEW QUESTION 92**

- (Exam Topic 1)

A business is looking for a cloud service provider that offers a la carte services, including cloud backups, VM elasticity, and secure networking. Which of the following cloud service provider types should business engage?

- A. A IaaS
- B. PaaS
- C. XaaS
- D. SaaS

**Answer:** A

**Explanation:**

Infrastructure as a Service (IaaS) providers offer a la carte services, including cloud backups, VM elasticity, and secure networking. With IaaS, businesses can rent infrastructure components such as virtual machines, storage, and networking from a cloud service provider. References: CompTIA Security+ Study Guide, pages 233-234

**NEW QUESTION 97**

- (Exam Topic 1)

A large enterprise has moved all its data to the cloud behind strong authentication and encryption. A sales director recently had a laptop stolen, and later, enterprise data was found to have been compromised from a local database. Which of the following was the MOST likely cause?

- A. Shadow IT
- B. Credential stuffing
- C. SQL injection
- D. Man in the browser
- E. Bluejacking

**Answer:** A

**Explanation:**

The most likely cause of the enterprise data being compromised from a local database is Shadow IT. Shadow IT is the use of unauthorized applications or devices by employees to access company resources. In this case, the sales director's laptop was stolen, and the attacker was able to use it to access the local database, which was not secured properly, allowing unauthorized access to sensitive data. References:

➤ [CompTIA Security+ Certification Exam Objectives - Exam SY0-601](#)

**NEW QUESTION 102**

- (Exam Topic 1)

A Chief information Officer is concerned about employees using company-issued laptops to steal data when accessing network shares Which of the following should the company implement?

- A. DLP
- B. CASB
- C. HIDS
- D. EDR
- E. UEFI

**Answer:** A

**Explanation:**

Detailed

Data Loss Prevention (DLP) can help prevent employees from stealing data by monitoring and controlling access to sensitive data. DLP can also detect and block attempts to transfer sensitive data outside of the organization, such as via email, file transfer, or cloud storage.

References: CompTIA Security+ Study Guide: Exam SY0-601, Chapter 10: Managing Identity and Access, p. 465

**NEW QUESTION 107**

- (Exam Topic 1)

After segmenting the network, the network manager wants to control the traffic between the segments. Which of the following should the manager use to control the network traffic?

- A. A DMZ
- B. A VPN a
- C. A VLAN
- D. An ACL

**Answer:** D

**Explanation:**

After segmenting the network, a network manager can use an access control list (ACL) to control the traffic between the segments. An ACL is a set of rules that permit or deny traffic based on its characteristics, such as the source and destination IP addresses, protocol type, and port number. References: CompTIA Security+ Certification Guide, Exam SY0-501

**NEW QUESTION 112**

- (Exam Topic 1)

Which of the following would be BEST for a technician to review to determine the total risk an organization can bear when assessing a "cloud-first" adoption strategy?

- A. Risk matrix
- B. Risk tolerance
- C. Risk register
- D. Risk appetite

**Answer:** B

**Explanation:**

To determine the total risk an organization can bear, a technician should review the organization's risk tolerance, which is the amount of risk the organization is willing to accept. This information will help determine the organization's "cloud-first" adoption strategy. References: CompTIA Security+ Certification Exam Objectives (SY0-601)

**NEW QUESTION 115**

- (Exam Topic 1)

A developer is building a new portal to deliver single-pane-of-glass management capabilities to customers with multiple firewalls. To Improve the user experience, the developer wants to implement an authentication and authorization standard that uses security tokens that contain assertions to pass user Information between nodes. Which of the following roles should the developer configure to meet these requirements? (Select TWO).

- A. Identity processor
- B. Service requestor
- C. Identity provider
- D. Service provider
- E. Tokenized resource

F. Notarized referral

**Answer:** CD

**Explanation:**

An identity provider (IdP) is responsible for authenticating users and generating security tokens containing user information. A service provider (SP) is responsible for accepting security tokens and granting access to resources based on the user's identity.

**NEW QUESTION 119**

- (Exam Topic 1)

A security researcher has alerted an organization that its sensitive user data was found for sale on a website. Which of the following should the organization use to inform the affected parties?

- A. An incident response plan
- B. A communications plan
- C. A business continuity plan
- D. A disaster recovery plan

**Answer:** B

**Explanation:**

A communications plan should be used to inform the affected parties about the sale of sensitive user data on a website. The communications plan should detail how the organization will handle media inquiries, how to communicate with customers, and how to respond to other interested parties.

**NEW QUESTION 120**

- (Exam Topic 1)

The Chief Information Security Officer (CISO) has decided to reorganize security staff to concentrate on incident response and to outsource outbound Internet URL categorization and filtering to an outside company. Additionally, the CISO would like this solution to provide the same protections even when a company laptop or mobile device is away from a home office. Which of the following should the CISO choose?

- A. CASB
- B. Next-generation SWG
- C. NGFW
- D. Web-application firewall

**Answer:** B

**Explanation:**

The solution that the CISO should choose is Next-generation Secure Web Gateway (SWG), which provides URL filtering and categorization to prevent users from accessing malicious sites, even when they are away from the office. NGFWs are typically cloud-based and offer multiple security layers, including malware detection, intrusion prevention, and data loss prevention. References:

➤ CompTIA Security+ Study Guide Exam SY0-601, Chapter 4

**NEW QUESTION 124**

- (Exam Topic 1)

The technology department at a large global company is expanding its Wi-Fi network infrastructure at the headquarters building Which of the following should be closely coordinated between the technology, cybersecurity, and physical security departments?

- A. Authentication protocol
- B. Encryption type
- C. WAP placement
- D. VPN configuration

**Answer:** C

**Explanation:**

WAP stands for wireless access point, which is a device that allows wireless devices to connect to a wired network using Wi-Fi or Bluetooth. WAP placement refers to where and how WAPs are installed in a building or area.

WAP placement should be closely coordinated between the technology, cybersecurity, and physical security departments because it affects several aspects of network performance and security, such as:

- Coverage: WAP placement determines how well wireless devices can access the network throughout the building or area. WAPs should be placed in locations that provide optimal signal strength and avoid interference from other sources.
- Capacity: WAP placement determines how many wireless devices can connect to the network simultaneously without affecting network speed or quality. WAPs should be placed in locations that balance network load and avoid congestion or bottlenecks.
- Security: WAP placement determines how vulnerable wireless devices are to eavesdropping or hacking attacks from outside or inside sources. WAPs should be placed in locations that minimize exposure to unauthorized access and maximize encryption and authentication methods.

**NEW QUESTION 125**

- (Exam Topic 1)

one of the attendees starts to notice delays in the connection. and the HTTPS site requests are reverting to HTTP. Which of the following BEST describes what is happening?

- A. Birthday collision on the certificate key
- B. DNS hacking to reroute traffic
- C. Brute force to the access point
- D. A SSL/TLS downgrade

**Answer:** D



**Explanation:**

The scenario describes a Man-in-the-Middle (MitM) attack where the attacker intercepts traffic and downgrades the secure SSL/TLS connection to an insecure HTTP connection. This type of attack is commonly known as SSL/TLS downgrade attack or a stripping attack. The attacker is able to see and modify the communication between the client and server.

**NEW QUESTION 130**

- (Exam Topic 1)

A security engineer needs to create a network segment that can be used for servers that require connections from untrusted networks. Which of the following should the engineer implement?

- A. An air gap
- B. A hot site
- C. A VUAN
- D. A screened subnet

**Answer:** D

**Explanation:**

A screened subnet is a network segment that can be used for servers that require connections from untrusted networks. It is placed between two firewalls, with one firewall facing the untrusted network and the other facing the trusted network. This setup provides an additional layer of security by screening the traffic that flows between the two networks. References: CompTIA Security+ Certification Guide, Exam SY0-501

**NEW QUESTION 133**

- (Exam Topic 1)

The compliance team requires an annual recertification of privileged and non-privileged user access. However, multiple users who left the company six months ago still have access. Which of the following would have prevented this compliance violation?

- A. Account audits
- B. AUP
- C. Password reuse
- D. SSO

**Answer:** A

**Explanation:**

Account audits are periodic reviews of user accounts to ensure that they are being used appropriately and that access is being granted and revoked in accordance with the organization's policies and procedures. If the compliance team had been conducting regular account audits, they would have identified the users who left the company six months ago and ensured that their access was revoked in a timely manner. This would have prevented the compliance violation caused by these users still having access to the company's systems.

To prevent this compliance violation, the company should implement account audits. An account audit is a regular review of all user accounts to ensure that they are being used properly and that they are in compliance with the company's security policies. By conducting regular account audits, the company can identify inactive or unused accounts and remove access for those users. This will help to prevent compliance violations and ensure that only authorized users have access to the company's systems and data.

**NEW QUESTION 134**

- (Exam Topic 1)

An employee's company account was used in a data breach Interviews with the employee revealed:

- The employee was able to avoid changing passwords by using a previous password again.
- The account was accessed from a hostile, foreign nation, but the employee has never traveled to any other countries.

Which of the following can be implemented to prevent these issues from reoccurring? (Select TWO)

- A. Geographic dispersal
- B. Password complexity
- C. Password history
- D. Geotagging
- E. Password lockout
- F. Geofencing

**Answer:** CF

**Explanation:**

two possible solutions that can be implemented to prevent these issues from reoccurring are password history and geofencing. Password history is a feature that prevents users from reusing their previous passwords. This can enhance password security by forcing users to create new and unique passwords periodically. Password history can be configured by setting a policy that specifies how many previous passwords are remembered and how often users must change their passwords.

Geofencing is a feature that restricts access to a system or network based on the geographic location of the user or device. This can enhance security by preventing unauthorized access from hostile or foreign regions. Geofencing can be implemented by using GPS, IP address, or other methods to determine the location of the user or device and compare it with a predefined set of boundaries.

**NEW QUESTION 139**

- (Exam Topic 1)

A network analyst is setting up a wireless access point for a home office in a remote, rural location. The requirement is that users need to connect to the access point securely but do not want to have to remember passwords Which of the following should the network analyst enable to meet the requirement?

- A. MAC address filtering
- B. 802.1X
- C. Captive portal
- D. WPS



**Answer:** D

**Explanation:**

The network analyst should enable Wi-Fi Protected Setup (WPS) to allow users to connect to the wireless access point securely without having to remember passwords. WPS allows users to connect to a wireless network by pressing a button or entering a PIN instead of entering a password.

Reference: CompTIA Security+ Study Guide, Exam SY0-601, Chapter 4: Identity and Access Management

**NEW QUESTION 140**

- (Exam Topic 1)

The SIEM at an organization has detected suspicious traffic coming a workstation in its internal network. An analyst in the SOC the workstation and discovers malware that is associated with a botnet is installed on the device A review of the logs on the workstation reveals that the privileges of the local account were escalated to a local administrator. To which of the following groups should the analyst report this real-world event?

- A. The NOC team
- B. The vulnerability management team
- C. The CIRT
- D. The read team

**Answer:** C

**Explanation:**

The Computer Incident Response Team (CIRT) is responsible for handling incidents and ensuring that the incident response plan is followed. References: CompTIA Security+ Study Guide, Exam SY0-601, Chapter 9

**NEW QUESTION 144**

- (Exam Topic 1)

Remote workers in an organization use company-provided laptops with locally installed applications and locally stored data Users can store data on a remote server using an encrypted connection. The organization discovered data stored on a laptop had been made available to the public Which of the following security solutions would mitigate the risk of future data disclosures?

- A. FDE
- B. TPM
- C. HIDS
- D. VPN

**Answer:** A

**Explanation:**

Based on these definitions, the best security solution to mitigate the risk of future data disclosures from a laptop would be FDE123. FDE would prevent unauthorized access to the data stored on the laptop even if it is stolen or lost. FDE can also use TPM to store the encryption key and ensure that only trusted software can decrypt the data3. HIDS and VPN are not directly related to data encryption, but they can provide additional security benefits by detecting intrusions and protecting network traffic respectively.

**NEW QUESTION 149**

- (Exam Topic 1)

A security analyst reports a company policy violation in a case in which a large amount of sensitive data is being downloaded after hours from various mobile devices to an external site. Upon further investigation, the analyst notices that successful login attempts are being conducted with impossible travel times during the same time periods when the unauthorized downloads are occurring. The analyst also discovers a couple of WAPs are using the same SSID, but they have non-standard DHCP configurations and an overlapping channel. Which of the following attacks is being conducted?

- A. Evil twin
- B. Jamming
- C. DNS poisoning
- D. Bluesnarfing
- E. DDoS

**Answer:** A

**Explanation:**

The attack being conducted is an Evil twin attack. An Evil twin attack involves creating a rogue wireless access point (WAP) with the same Service Set Identifier (SSID) as a legitimate WAP to trick users into connecting to it. Once connected, the attacker can intercept traffic or steal login credentials. The successful login attempts with impossible travel times suggest that an attacker is using a stolen or compromised credential to access the external site to which the sensitive data is being downloaded. The non-standard DHCP configurations and overlapping channels of the WAPs suggest that the attacker is using a rogue WAP to intercept traffic. References: CompTIA Security+ Certification Exam Objectives, Exam Domain 1.0: Attacks, Threats, and Vulnerabilities, 1.4 Compare and contrast types of attacks, p. 8

**NEW QUESTION 154**

- (Exam Topic 1)

The Chief Information Security Officer directed a risk reduction in shadow IT and created a policy requiring all unsanctioned high-risk SaaS applications to be blocked from user access Which of the following is the BEST security solution to reduce this risk?

- A. CASB
- B. VPN concentrator
- C. MFA
- D. VPC endpoint

**Answer:** A

**Explanation:**

A Cloud Access Security Broker (CASB) can be used to monitor and control access to cloud-based applications, including unsanctioned SaaS applications. It can help enforce policies that prevent access to high-risk SaaS applications and provide visibility into the use of such applications by employees. References: CompTIA Security+ SY0-601 Exam Objectives: 3.3 Given a scenario, implement secure mobile solutions.

#### NEW QUESTION 159

- (Exam Topic 2)

A financial institution recently joined a bug bounty program to identify security issues in the institution's new public platform. Which of the following best describes who the institution is working with to identify security issues?

- A. Script kiddie
- B. Insider threats
- C. Malicious actor
- D. Authorized hacker

**Answer:** D

#### Explanation:

An authorized hacker, also known as an ethical hacker or a white hat hacker, is someone who uses their skills and knowledge to find and report security issues in a system or application with the permission of the owner. An authorized hacker follows the rules and guidelines of the bug bounty program and does not cause any harm or damage to the system or its users.

#### NEW QUESTION 160

- (Exam Topic 2)

Which of the following can reduce vulnerabilities by avoiding code reuse?

- A. Memory management
- B. Stored procedures
- C. Normalization
- D. Code obfuscation

**Answer:** A

#### Explanation:

Memory management is a technique that can allocate and deallocate memory for applications and processes. Memory management can reduce vulnerabilities by avoiding code reuse, which is a technique that exploits a memory corruption vulnerability to execute malicious code that already exists in memory. Memory management can prevent code reuse by implementing features such as address space layout randomization (ASLR), data execution prevention (DEP), or stack canaries.

#### NEW QUESTION 164

- (Exam Topic 2)

A company recently upgraded its authentication infrastructure and now has more computing power. Which of the following should the company consider using to ensure user credentials are being transmitted and stored more securely?

- A. Blockchain
- B. Salting
- C. Quantum
- D. Digital signature

**Answer:** B

#### Explanation:

Salting is a technique that adds random data to user credentials before hashing them. This makes the hashed credentials more secure and resistant to brute-force attacks or rainbow table attacks. Salting also ensures that two users with the same password will have different hashed credentials.

A company that has more computing power can consider using salting to ensure user credentials are being transmitted and stored more securely. Salting can increase the complexity and entropy of the hashed credentials, making them harder to crack or reverse.

#### NEW QUESTION 165

- (Exam Topic 2)

An analyst is working on an email security incident in which the target opened an attachment containing a worm. The analyst wants to Implement mitigation techniques to prevent further spread. Which of the following is the best course of action for the analyst to take?

- A. Apply a DLP solution.
- B. Implement network segmentation.
- C. Utilize email content filtering.
- D. Isolate the infected attachment.

**Answer:** D

#### Explanation:

Isolating the infected attachment is the best course of action for the analyst to take to prevent further spread of the worm. A worm is a type of malware that can self-replicate and infect other devices without human interaction. By isolating the infected attachment, the analyst can prevent the worm from spreading to other devices or networks via email, file-sharing, or other means. Isolating the infected attachment can also help the analyst to analyze the worm and determine its source, behavior, and impact. References:

> <https://www.security.org/antivirus/computer-worm/>

> [https://sec.cloudapps.cisco.com/security/center/resources/worm\\_mitigation\\_whitepaper.html](https://sec.cloudapps.cisco.com/security/center/resources/worm_mitigation_whitepaper.html)

#### NEW QUESTION 168

- (Exam Topic 2)

A company wants to deploy decoy systems alongside production systems in order to entice threat actors and to learn more about attackers. Which of the following best describes these systems?

- A. DNS sinkholes
- B. Honey pots
- C. Virtual machines
- D. Neural networks

**Answer:** B

#### Explanation:

Honey pots are decoy systems or resources that are designed to attract and deceive threat actors and to learn more about their motives, techniques, etc. They can be deployed alongside production systems to create an illusion of a vulnerable target and divert attacks away from the real systems. They can also collect valuable information and evidence about the attackers and their activities for further analysis or prosecution.

#### NEW QUESTION 171

- (Exam Topic 2)

Which of the following would be used to find the most common web-application vulnerabilities?

- A. OWASP
- B. MITRE ATT&CK
- C. Cyber Kill Chain
- D. SDLC

**Answer:** A

#### Explanation:

OWASP (Open Web Application Security Project) is a non-profit organization that provides resources and guidance for improving the security of web applications. It publishes a list of the most common web application vulnerabilities, such as injection, broken authentication, cross-site scripting, etc., and provides recommendations and best practices for preventing and mitigating them

#### NEW QUESTION 176

- (Exam Topic 2)

An organization recently released a software assurance policy that requires developers to run code scans each night on the repository. After the first night, the security team alerted the developers that more than 2,000 findings were reported and need to be addressed. Which of the following is the MOST likely cause for the high number of findings?

- A. The vulnerability scanner was not properly configured and generated a high number of false positives
- B. Third-party libraries have been loaded into the repository and should be removed from the codebase.
- C. The vulnerability scanner found several memory leaks during runtime, causing duplicate reports for the same issue.
- D. The vulnerability scanner was not loaded with the correct benchmarks and needs to be updated.

**Answer:** A

#### Explanation:

The most likely cause for the high number of findings is that the vulnerability scanner was not properly configured and generated a high number of false positives. False positive results occur when a vulnerability scanner incorrectly identifies a non-vulnerable system or application as being vulnerable. This can happen due to incorrect configuration, over-sensitive rule sets, or outdated scan databases.

<https://www.professormesser.com/security-plus/sy0-601/sy0-601-video/sy0-601-comptia-security-plus-course/>

#### NEW QUESTION 180

- (Exam Topic 2)

A manager for the development team is concerned about reports showing a common set of vulnerabilities. The set of vulnerabilities is present on almost all of the applications developed by the team. Which of the following approaches would be most effective for the manager to use to address this issue?

- A. Tune the accuracy of fuzz testing.
- B. Invest in secure coding training and application security guidelines.
- C. Increase the frequency of dynamic code scans to detect issues faster.
- D. Implement code signing to make code immutable.

**Answer:** B

#### Explanation:

Invest in secure coding training and application security guidelines is the most effective approach for the manager to use to address the issue of common vulnerabilities in the applications developed by the team. Secure coding training can help the developers learn how to write code that follows security best practices and avoids common mistakes or flaws that can introduce vulnerabilities. Application security guidelines can provide a set of standards and rules for developing secure applications that meet the company's security requirements and policies. By investing in secure coding training and application security guidelines, the manager can improve the security awareness and skills of the development team and reduce the number of vulnerabilities in their applications. References: 1

CompTIA Security+ Certification Exam Objectives, page 9,

Domain 2.0: Architecture and Design, Objective 2.3: Summarize secure application development, deployment, and automation concepts 2

CompTIA Security+ Certification Exam Objectives, page 10, Domain 2.0:

Architecture and Design, Objective 2.4: Explain the importance of embedded and specialized systems security 3 <https://www.comptia.org/blog/what-is-secure-coding>

#### NEW QUESTION 184

- (Exam Topic 2)

Which of the following would be most effective to contain a rapidly spreading attack that is affecting a large number of organizations?

- A. Machine learning
- B. DNS sinkhole
- C. Blocklist
- D. Honey pot

**Answer:** B

**Explanation:**

A DNS sinkhole would be most effective to contain a rapidly spreading attack that is affecting a large number of organizations. A DNS sinkhole is a technique that involves redirecting malicious or unwanted domain names to an alternative IP address, such as a black hole, a honeypot, or a warning page. A DNS sinkhole can help to prevent or disrupt the communication between infected systems and command-and-control servers, malware distribution sites, phishing sites, or botnets. A DNS sinkhole can also help to identify and isolate infected systems by monitoring the traffic to the sinkhole IP address. References:

<https://www.comptia.org/blog/what-is-a-dns-sinkhole>

<https://www.certblaster.com/wp-content/uploads/2020/11/CompTIA-Security-SY0-601-Exam-Objectives-1.0.pdf>

**NEW QUESTION 187**

- (Exam Topic 2)

A security analyst is reviewing the output of a web server log and notices a particular account is attempting to transfer large amounts of money:

GET

[http://yourbank.com/transfer.do?acctnum=087646959](http://yourbank.com/transfer.do?acctnum=087646959&amount=500000)

&amount=500000 HTTP/1.1

GET

[http://yourbank.com/transfer.do?acctnum=087646958](http://yourbank.com/transfer.do?acctnum=087646958&amount=5000000)

&amount=5000000 HTTP/1.1

GET

[http://yourbank.com/transfer.do?acctnum=-087646958](http://yourbank.com/transfer.do?acctnum=-087646958&amount=1000000)

&amount=1000000 HTTP/1.1

GET

[http://yourbank.com/transfer.do?acctnum=087646953](http://yourbank.com/transfer.do?acctnum=087646953&amount=500)

&amount=500 HTTP/1.1

Which of the following types of attacks is most likely being conducted?

- A. SQLi
- B. CSRF
- C. Spear phishing
- D. API

**Answer:** B

**Explanation:**

CSRF stands for Cross-Site Request Forgery, which is an attack that forces an end user to execute unwanted actions on a web application in which they are currently authenticated<sup>1</sup>. In this case, the attacker may have tricked the user into clicking a malicious link or visiting a malicious website that sends forged requests to the web server of the bank, using the user's session cookie or other credentials. The web server then performs the money transfer requests as if they were initiated by the user, without verifying the origin or validity of the requests.

\* A. SQLi. This is not the correct answer, because SQLi stands for SQL Injection, which is an attack that exploits a vulnerability in a web application's database layer, where malicious SQL statements are inserted into an entry field for execution<sup>2</sup>. The output of the web server log does not show any SQL statements or commands.

\* B. CSRF. This is the correct answer, because CSRF is an attack that exploits the trust a web server has in a user's browser, where malicious requests are sent to the web server using the user's credentials<sup>1</sup>. The output of the web server log shows multiple GET requests with different account numbers and amounts, which may indicate a CSRF attack.

\* C. Spear phishing. This is not the correct answer, because spear phishing is an attack that targets a specific individual or organization with a personalized email or message that contains a malicious link or attachment<sup>3</sup>. The output of the web server log does not show any email or message content or headers.

\* D. API. This is not the correct answer, because API stands for Application Programming Interface, which is a set of rules and specifications that allow software components to communicate and exchange data. API is not an attack method, but rather a way of designing and developing software applications.

**NEW QUESTION 188**

- (Exam Topic 2)

An annual information security has revealed that several OS-level configurations are not in compliance due to Outdated hardening standards the company is using Which Of the following would be best to use to update and reconfigure the OS.level security configurations?

- A. CIS benchmarks
- B. GDPR guidance
- C. Regional regulations
- D. ISO 27001 standards

**Answer:** A

**Explanation:**

CIS benchmarks are best practices and standards for securing various operating systems, applications, cloud environments, etc. They are developed by a community of experts and updated regularly to reflect the latest threats and vulnerabilities. They can be used to update and reconfigure the OS-level security configurations to ensure compliance and reduce risks

**NEW QUESTION 189**

- (Exam Topic 2)

A web server has been compromised due to a ransomware attack. Further Investigation reveals the ransomware has been in the server for the past 72 hours. The systems administrator needs to get the services back up as soon as possible. Which of the following should the administrator use to restore services to a secure state?



- A. The last incremental backup that was conducted 72 hours ago
- B. The last known-good configuration stored by the operating system
- C. The last full backup that was conducted seven days ago
- D. The baseline OS configuration

**Answer:** A

**Explanation:**

The last incremental backup that was conducted 72 hours ago would be the best option to restore the services to a secure state, as it would contain the most recent data before the ransomware infection. Incremental backups only store the changes made since the last backup, so they are faster and use less storage space than full backups. Restoring from an incremental backup would also minimize the data loss and downtime caused by the ransomware attack. References:

- > <https://www.comptia.org/blog/mature-cybersecurity-response-to-ransomware>
- > <https://www.youtube.com/watch?v=HszU4nEAlFc>

**NEW QUESTION 193**

- (Exam Topic 2)

A security analyst is assisting a team of developers with best practices for coding. The security analyst would like to defend against the use of SQL injection attacks. Which of the following should the security analyst recommend first?

- A. Tokenization
- B. Input validation
- C. Code signing
- D. Secure cookies

**Answer:** B

**Explanation:**

Input validation is a technique that involves checking the user input for any malicious or unexpected characters or commands that could be used to perform SQL injection attacks. Input validation can be done by using allow-lists or deny-lists to filter out the input based on predefined criteria. Input validation can prevent SQL injection attacks by ensuring that only valid and expected input is passed to the database queries.

**NEW QUESTION 194**

- (Exam Topic 2)

The alert indicates an attacker entered thousands of characters into the text box of a web form. The web form was intended for legitimate customers to enter their phone numbers. Which of the attacks has most likely occurred?

- A. Privilege escalation
- B. Buffer overflow
- C. Resource exhaustion
- D. Cross-site scripting

**Answer:** B

**Explanation:**

A buffer overflow attack occurs when an attacker inputs more data than the buffer can store, causing the excess data to overwrite adjacent memory locations and corrupt or execute code<sup>1</sup>. In this case, the attacker entered thousands of characters into a text box that was intended for phone numbers, which are much shorter. This could result in a buffer overflow attack that compromises the web application or server. The other options are not related to this scenario. Privilege escalation is when an attacker gains unauthorized access to higher-level privileges or resources<sup>2</sup>. Resource exhaustion is when an attacker consumes all the available resources of a system, such as CPU, memory, disk space, etc., to cause a denial of service<sup>3</sup>. Cross-site scripting is when an attacker injects malicious code into a web page that is executed by the browser of a victim who visits the page.

References: 1: <https://www.fortinet.com/resources/cyberglossary/buffer-overflow> 2:

<https://www.imperva.com/learn/application-security/privilege-escalation/> 3: <https://www.imperva.com/learn/application-security/resource-exhaustion/> :

<https://owasp.org/www-community/attacks/xss/>

**NEW QUESTION 198**

- (Exam Topic 2)

A data center has experienced an increase in under-voltage events. Following electrical grid maintenance outside the facility, these events are leading to occasional losses of system availability. Which of the following would be the most cost-effective solution for the data center to implement?

- A. Uninterruptible power supplies with battery backup
- B. Managed power distribution units to track these events
- C. A generator to ensure consistent, normalized power delivery
- D. Dual power supplies to distribute the load more evenly

**Answer:** A

**Explanation:**

Uninterruptible power supplies with battery backup would be the most cost-effective solution for the data center to implement to prevent under-voltage events following electrical grid maintenance outside the facility. An uninterruptible power supply (UPS) is a device that provides emergency power to a load when the main power source fails or drops below an acceptable level. A UPS with battery backup can help prevent under-voltage events by switching to battery power when it detects a voltage drop or outage in the main power source. A UPS with battery backup can also protect the data center equipment from power surges or spikes.

References: <https://www.comptia.org/certifications/security#examdetails> <https://www.comptia.org/content/guides/comptia-security-sy0-601-exam-objectives>

<https://www.apc.com/us/en/faqs/FA158852/>

**NEW QUESTION 200**

- (Exam Topic 2)

A report delivered to the Chief Information Security Officer (CISO) shows that some user credentials could be exfiltrated. The report also indicates that users tend to choose the same credentials on different systems and applications. Which of the following policies should the CISO use to prevent someone from using the



exfiltrated credentials?

- A. MFA
- B. Lockout
- C. Time-based logins
- D. Password history

**Answer:** A

**Explanation:**

MFA stands for multi-factor authentication, which is a method of verifying a user's identity using two or more factors, such as something you know (e.g., password), something you have (e.g., token), or something you are (e.g., biometrics). MFA can prevent someone from using the exfiltrated credentials, as they would need to provide another factor besides the username and password to access the system or application. MFA can also alert the legitimate user of an unauthorized login attempt, allowing them to change their credentials or report the incident. References:

- > <https://www.comptia.org/certifications/security>
- > <https://www.youtube.com/watch?v=yCJyPPvM-xg>
- > <https://www.professormesser.com/security-plus/sy0-601/sy0-601-video/multi-factor-authentication-5/>

**NEW QUESTION 203**

- (Exam Topic 2)

Which of the following is required in order (or an IDS and a WAF to be effective on HTTPS traffic?

- A. Hashing
- B. DNS sinkhole
- C. TLS inspection
- D. Data masking

**Answer:** C

**Explanation:**

TLS (Transport Layer Security) is a protocol that is used to encrypt data sent over HTTPS (Hypertext Transfer Protocol Secure). In order for an intrusion detection system (IDS) and a web application firewall (WAF) to be effective on HTTPS traffic, they must be able to inspect the encrypted traffic. TLS inspection allows the IDS and WAF to decrypt and inspect the traffic, allowing them to detect any malicious activity. References: [1] CompTIA Security+ Study Guide Exam SY0-601 [1], Sixth Edition, Chapter 11, "Network Security Monitoring" [2] CompTIA Security+ Get Certified Get Ahead: SY0-501 Study Guide, Chapter 7, "Intrusion Detection and Prevention"

**NEW QUESTION 204**

- (Exam Topic 2)

A security team is providing input on the design of a secondary data center that has Which of the following should the security team recommend? (Select two).

- A. Configuring replication of the web servers at the primary site to offline storage
- B. Constructing the secondary site in a geographically disperse location
- C. Deploying load balancers at the primary site
- D. Installing generators
- E. Using differential backups at the secondary site
- F. Implementing hot and cold aisles at the secondary site

**Answer:** BD

**Explanation:**

\* B. Constructing the secondary site in a geographically disperse location would ensure that a natural disaster at the primary site would not affect the secondary site. It would also allow for failover during traffic surge situations by distributing the load across different regions. D. Installing generators would provide protection against power surges and outages by providing backup power sources in case of a failure. Generators are part of the physical security requirements for data centers as they ensure availability and resilience. References: 1

CompTIA Security+ Certification Exam Objectives, page 8, Domain 2.0: Architecture and Design, Objective 2.1 : Explain the importance of secure staging deployment concepts 2

CompTIA Security+ Certification Exam

Objectives, page 9, Domain 2.0: Architecture and Design, Objective 2.3: Summarize secure application development, deployment, and automation concepts 3

CompTIA Security+ Certification Exam Objectives, page 11, Domain 2.0: Architecture and Design, Objective 2.5: Explain the importance of physical security controls

**NEW QUESTION 206**

- (Exam Topic 2)

A network architect wants a server to have the ability to retain network availability even if one of the network switches it is connected to goes down. Which of the following should the architect implement on the server to achieve this goal?

- A. RAID
- B. UPS
- C. NIC teaming
- D. Load balancing

**Answer:** C

**Explanation:**

NIC Teaming is a feature that allows a server to be connected to multiple network switches, providing redundancy and increased network availability. If one of the switches goes down, the server will still be able to send and receive data through one of the other switches. To configure NIC Teaming in Windows Server, see Microsoft's documentation:

<https://docs.microsoft.com/en-us/windows-server/networking/technologies/nic-teaming>. For more information on NIC Teaming and other network redundancy

features, refer to the CompTIA Security+ SY0-601 Official Text Book and Resources.

#### NEW QUESTION 207

- (Exam Topic 2)

Which Of the following best ensures minimal downtime for organizations vÃh crit-ical computing equipment located in earthquake-prone areas?

- A. Generators and UPS
- B. Off-site replication
- C. Additional warm site
- D. Local

**Answer:** B

#### Explanation:

Off-site replication is a process of copying and storing data in a remote location that is geographically separate from the primary site. It can ensure minimal downtime for organizations with critical computing equipment located in earthquake-prone areas by providing a backup copy of data that can be accessed and restored in case of a disaster or disruption at the primary site.

#### NEW QUESTION 211

- (Exam Topic 2)

A company wants to deploy PKI on its internet-facing website The applications that are currently deployed are

- www company.com (mam website)
- contact us company com (for locating a nearby location)
- quotes company.com (for requesting a price quote)

The company wants to purchase one SSL certificate that will work for all the existing applications and any future applications that follow the same naming conventions, such as store company com Which of the following certificate types would best meet the requirements?

- A. SAN
- B. Wildcard
- C. Extended validation
- D. Self-signed

**Answer:** B

#### Explanation:

A wildcard certificate is a type of SSL certificate that can secure multiple subdomains under one domain name by using an asterisk (\*) as a placeholder for any subdomain name. For example, \*.company.com can secure www.company.com, contactus.company.com, quotes.company.com, etc. It can work for all the existing applications and any future applications that follow the same naming conventions, such as store.company.com.

#### NEW QUESTION 215

- (Exam Topic 2)

A security team will be outsourcing several key functions to a third party and will require that:

- Several of the functions will carry an audit burden.
- Attestations will be performed several times a year.
- Reports will be generated on a monthly basis.

Which of the following BEST describes the document that is used to define these requirements and stipulate how and when they are performed by the third party?

- A. MOU
- B. AUP
- C. SLA
- D. MSA

**Answer:** C

#### Explanation:

A service level agreement (SLA) is a contract between a service provider and a customer that outlines the services that are to be provided and the expected levels of performance. It is used to define the requirements for the service, including any attestations and reports that must be generated, and the timescales in which these must be completed. It also outlines any penalties for failing to meet these requirements. SLAs are essential for ensuring that third-party services are meeting the agreed upon performance levels.

Reference: CompTIA Security+ Study Guide: SY0-601 by Emmett Dulaney, Chuck Easttom <https://www.wiley.com/en-us/CompTIA+Security%2B+Study+Guide%3A+SY0-601-p-9781119515968>

CompTIA Security+ Get Certified Get Ahead: SY0-601 Study Guide by Darril Gibson <https://www.amazon.com/CompTIA-Security-Certified-Ahead-SY0-601/dp/1260117558>

Note: SLA is the best document that is used to define these requirements and stipulate how and when they are performed by the third party.

#### NEW QUESTION 219

- (Exam Topic 2)

Select the appropriate attack and remediation from each drop-down list to label the corresponding attack with its remediation.

#### INSTRUCTIONS

Not all attacks and remediation actions will be used.

If at any time you would like to bring back the initial state of the simulation, please click the Reset All button.

Attack Description	Target	Attack Identified	BEST Preventative or Remediation Action
An attacker sends multiple SYN packets from multiple sources.	Web server	<div> <div>▼</div> <div>Botnet</div> <div>RAT</div> <div>Logic Bomb</div> <div>Backdoor</div> <div>Virus</div> <div>Spyware</div> <div>Worm</div> <div>Adware</div> <div>Ransomware</div> <div>Keylogger</div> <div>Phishing</div> </div>	<div> <div>▼</div> <div>Enable DDoS protection</div> <div>Patch vulnerable systems</div> <div>Disable vulnerable services</div> <div>Change the default system password</div> <div>Update the cryptographic algorithms</div> <div>Change the default application password</div> <div>Implement 2FA using push notification</div> <div>Conduct a code review</div> <div>Implement application fuzzing</div> <div>Implement a host-based IPS</div> <div>Disable remote access services</div> </div>
The attack establishes a connection, which allows remote commands to be executed.	User	<div> <div>▼</div> <div>Botnet</div> <div>RAT</div> <div>Logic Bomb</div> <div>Backdoor</div> <div>Virus</div> <div>Spyware</div> <div>Worm</div> <div>Adware</div> <div>Ransomware</div> <div>Keylogger</div> <div>Phishing</div> </div>	<div> <div>▼</div> <div>Enable DDoS protection</div> <div>Patch vulnerable systems</div> <div>Disable vulnerable services</div> <div>Change the default system password</div> <div>Update the cryptographic algorithms</div> <div>Change the default application password</div> <div>Implement 2FA using push notification</div> <div>Conduct a code review</div> <div>Implement application fuzzing</div> <div>Implement a host-based IPS</div> <div>Disable remote access services</div> </div>
The attack is self propagating and compromises a SQL database using well-known credentials as it moves through the network.	Database server	<div> <div>▼</div> <div>Botnet</div> <div>RAT</div> <div>Logic Bomb</div> <div>Backdoor</div> <div>Virus</div> <div>Spyware</div> <div>Worm</div> <div>Adware</div> <div>Ransomware</div> <div>Keylogger</div> <div>Phishing</div> </div>	<div> <div>▼</div> <div>Enable DDoS protection</div> <div>Patch vulnerable systems</div> <div>Disable vulnerable services</div> <div>Change the default system password</div> <div>Update the cryptographic algorithms</div> <div>Change the default application password</div> <div>Implement 2FA using push notification</div> <div>Conduct a code review</div> <div>Implement application fuzzing</div> <div>Implement a host-based IPS</div> <div>Disable remote access services</div> </div>
The attacker uses hardware to remotely monitor a user's input activity to harvest credentials.	Executive	<div> <div>▼</div> <div>Botnet</div> <div>RAT</div> <div>Logic Bomb</div> <div>Backdoor</div> <div>Virus</div> <div>Spyware</div> <div>Worm</div> <div>Adware</div> <div>Ransomware</div> <div>Keylogger</div> <div>Phishing</div> </div>	<div> <div>▼</div> <div>Enable DDoS protection</div> <div>Patch vulnerable systems</div> <div>Disable vulnerable services</div> <div>Change the default system password</div> <div>Update the cryptographic algorithms</div> <div>Change the default application password</div> <div>Implement 2FA using push notification</div> <div>Conduct a code review</div> <div>Implement application fuzzing</div> <div>Implement a host-based IPS</div> <div>Disable remote access services</div> </div>
The attacker embeds hidden access in an internally developed application that bypasses account login.	Application	<div> <div>▼</div> <div>Botnet</div> <div>RAT</div> <div>Logic Bomb</div> <div>Backdoor</div> <div>Virus</div> <div>Spyware</div> <div>Worm</div> <div>Adware</div> <div>Ransomware</div> <div>Keylogger</div> <div>Phishing</div> </div>	<div> <div>▼</div> <div>Enable DDoS protection</div> <div>Patch vulnerable systems</div> <div>Disable vulnerable services</div> <div>Change the default system password</div> <div>Update the cryptographic algorithms</div> <div>Change the default application password</div> <div>Implement 2FA using push notification</div> <div>Conduct a code review</div> <div>Implement application fuzzing</div> <div>Implement a host-based IPS</div> <div>Disable remote access services</div> </div>

- A. Mastered  
B. Not Mastered

Answer: A

#### Explanation:

Web server Botnet Enable DDoS protection User RAT Implement a host-based IPS Database server Worm Change the default application password Executive Keylogger Disable vulnerable services Application Backdoor Implement 2FA using push notification  
A screenshot of a computer program Description automatically generated with low confidence

Attack Description	Target	Attack Identified	BEST Preventative or Remediation Action
An attacker sends multiple SYN packets from multiple sources.	Web server	Botnet ▼	Enable DDoS protection ▼
The attack establishes a connection, which allows remote commands to be executed.	User	RAT ▼	Implement a host-based IPS ▼
The attack is self propagating and compromises a SQL database using well-known credentials as it moves through the network.	Database server	Worm ▼	Change the default application password ▼
The attacker uses hardware to remotely monitor a user's input activity to harvest credentials.	Executive	Keylogger ▼	Disable vulnerable services ▼
The attacker embeds hidden access in an internally developed application that bypasses account login.	Application	Backdoor ▼	Implement 2FA using push notification ▼



**NEW QUESTION 220**

- (Exam Topic 2)

A security analyst is investigating what appears to be unauthorized access to a corporate web application. The security analyst reviews the web server logs and finds the following entries:

```
106.35.45.53 - - [22/May/2020:07:00:58 +0100] "GET /login?username=admin&pin=0000 HTTP/1.1" 200 11705
"http://www.example.com/login.php"
106.35.45.53 - - [22/May/2020:07:01:21 +0100] "GET /login?username=admin&pin=0001 HTTP/1.1" 200 11705
"http://www.example.com/login.php"
106.35.45.53 - - [22/May/2020:07:01:52 +0100] "GET /login?username=admin&pin=0002 HTTP/1.1" 200 11705
"http://www.example.com/login.php"
106.35.45.53 - - [22/May/2020:07:02:18 +0100] "GET /login?username=admin&pin=0003 HTTP/1.1" 200 11705
"http://www.example.com/login.php"
106.35.45.53 - - [22/May/2020:07:02:18 +0100] "GET /login?username=admin&pin=0004 HTTP/1.1" 200 11705
"http://www.example.com/login.php"
```

Which of the following password attacks is taking place?

- A. Dictionary
- B. Brute-force
- C. Rainbow table
- D. Spraying

**Answer:** D

**Explanation:**

Spraying is a password attack that involves trying a few common passwords against a large number of usernames. Spraying is different from brute-force attacks, which try many possible passwords against one username, or dictionary attacks, which try a list of words from a dictionary file against one username. Spraying is often used when the web application has a lockout policy that prevents multiple failed login attempts for the same username. Spraying can be detected by looking for patterns of failed login attempts from the same source IP address with different usernames and the same or similar passwords.

**NEW QUESTION 224**

- (Exam Topic 2)

An attacker is using a method to hide data inside of benign files in order to exfiltrate confidential data. Which of the following is the attacker most likely using?

- A. Base64 encoding
- B. Steganography
- C. Data encryption
- D. Perfect forward secrecy

**Answer:** B

**Explanation:**

Steganography is a technique for hiding data inside of benign files such as images, audio, or video. This can be used to exfiltrate confidential data without raising suspicion or detection.

References: How to Hide Files Inside Files [Images, Folder] - Raymond.CC Blog; How to Hide Data in a Secret Text File Compartment - How-To Geek; How to Hide Data Within an Image - Medium

**NEW QUESTION 228**

- (Exam Topic 2)

An organization is outlining data stewardship roles and responsibilities. Which of the following employee roles would determine the purpose of data and how to process it?

- A. Data custodian
- B. Data controller
- C. Data protection officer
- D. Data processor

**Answer:** B

**Explanation:**

A data controller is an employee role that would determine the purpose of data and how to process it. A data controller is a person or entity that decides why and how personal data is collected, used, stored, shared, or deleted. A data controller has the responsibility to comply with data protection laws and regulations, such as the General Data Protection Regulation (GDPR), and to ensure the rights and privacy of data subjects.

References: <https://www.comptia.org/blog/what-is-a-data-controller>

<https://www.certblaster.com/wp-content/uploads/2020/11/CompTIA-Security-SY0-601-Exam-Objectives-1.0.pdf>

**NEW QUESTION 232**

- (Exam Topic 2)

A newly purchased corporate WAP needs to be configured in the MOST secure manner possible. INSTRUCTIONS

Please click on the below items on the network diagram and configure them accordingly:

- > WAP
- > DHCP Server
- > AAA Server
- > Wireless Controller
- > LDAP Server

If at any time you would like to bring back the initial state of the simulation, please click the Reset All button.

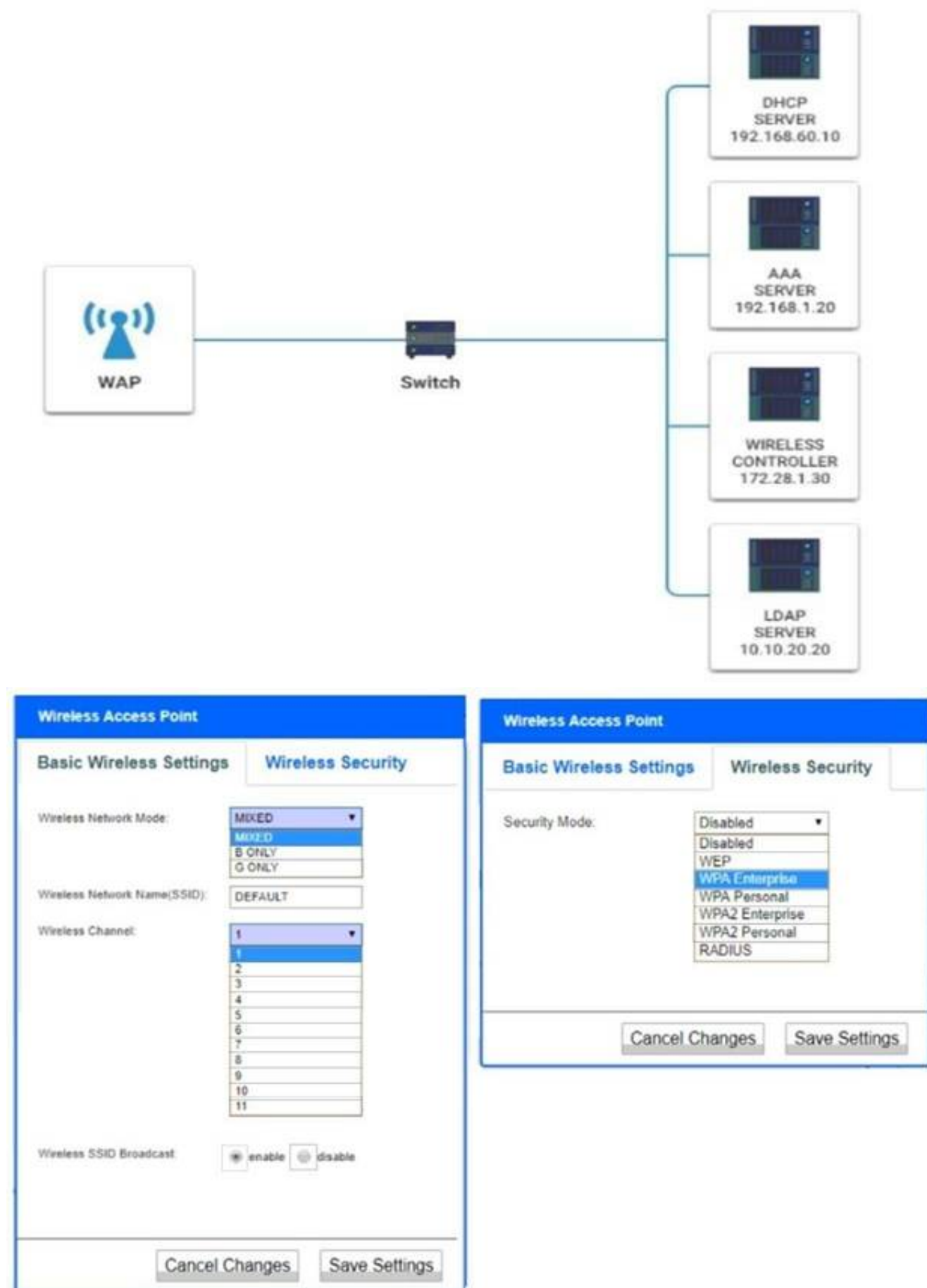

- A. Mastered
- B. Not Mastered

**Answer:** A

**Explanation:**

Wireless Access Point Network Mode – G only  
Wireless Channel – 11  
Wireless SSID Broadcast – disable  
Security settings – WPA2 Professional

**NEW QUESTION 233**

- (Exam Topic 2)

A company's help desk has received calls about the wireless network being down and users being unable to connect to it. The network administrator says all access points are up and running. One of the help desk technicians notices the affected users are working in a building near the parking lot. Which of the following is the most likely reason for the outage?

- A. Someone near the building is jamming the signal
- B. A user has set up a rogue access point near the building
- C. Someone set up an evil twin access point in the affected area.
- D. The APs in the affected area have been unplugged from the network

**Answer:** A

**Explanation:**

Jamming is a type of denial-of-service attack that involves interfering with or blocking the wireless signal using a device that emits radio waves at the same frequency as the wireless network. It can cause the wireless network to be down and users to be unable to connect to it, especially if they are working in a building near the parking lot where someone could easily place a jamming device.



#### NEW QUESTION 234

- (Exam Topic 2)

A company is moving to new location. The systems administrator has provided the following server room requirements to the facilities staff:

- Consistent power levels in case of brownouts or voltage spikes
- A minimum of 30 minutes runtime following a power outage
- Ability to trigger graceful shutdowns of critical systems

Which of the following would BEST meet the requirements?

- A. Maintaining a standby, gas-powered generator
- B. Using large surge suppressors on computer equipment
- C. Configuring managed PDUs to monitor power levels
- D. Deploying an appropriately sized, network-connected UPS device

**Answer:** D

#### Explanation:

A UPS (uninterruptible power supply) device is a battery backup system that can provide consistent power levels in case of brownouts or voltage spikes. It can also provide a minimum of 30 minutes runtime following a power outage, depending on the size and load of the device. A network-connected UPS device can also communicate with critical systems and trigger graceful shutdowns if the battery level is low or the power is not restored.

#### NEW QUESTION 236

- (Exam Topic 2)

Which of the following would help ensure a security analyst is able to accurately measure the overall risk to an organization when a new vulnerability is disclosed?

- A. A full inventory of all hardware and software
- B. Documentation of system classifications
- C. A list of system owners and their departments
- D. Third-party risk assessment documentation

**Answer:** A

#### Explanation:

A full inventory of all hardware and software would help ensure a security analyst is able to accurately measure the overall risk to an organization when a new vulnerability is disclosed, as it would allow the analyst to identify which systems and applications are affected by the vulnerability and prioritize the remediation efforts accordingly. A full inventory would also help the analyst to determine the impact and likelihood of a successful exploit, as well as the potential loss of confidentiality, integrity and availability of the data and services. References:

- <https://www.professormesser.com/security-plus/sy0-601/sy0-601-video/risk-analysis/>
- <https://www.comptia.org/landing/securityplus/index.html>
- <https://www.comptia.org/blog/complete-guide-to-risk-management>

#### NEW QUESTION 241

- (Exam Topic 2)

A security operations center wants to implement a solution that can execute files to test for malicious activity. The solution should provide a report of the files' activity against known threats.

Which of the following should the security operations center implement?

- A. theHarvester
- B. Nessus
- C. Cuckoo
- D. Sn1per

**Answer:** C

#### Explanation:

Cuckoo is a sandbox that is specifically written to run programs inside and identify any malware. A sandbox is a virtualized environment that isolates the program from the rest of the system and monitors its behavior. Cuckoo can analyze files of various types, such as executables, documents, URLs, and more. Cuckoo can provide a report of the files' activity against known threats, such as network traffic, file operations, registry changes, API calls, and so on.

A security operations center can implement Cuckoo to execute files to test for malicious activity and generate a report of the analysis. Cuckoo can help the security operations center to detect and prevent malware infections, investigate incidents, and perform threat intelligence.

#### NEW QUESTION 245

- (Exam Topic 2)

A company has hired an assessment team to test the security of the corporate network and employee vigilance. Only the Chief Executive Officer and Chief Operating Officer are aware of this exercise, and very little information has been provided to the assessors. Which of the following is taking place?

- A. A red-team test
- B. A white-team test
- C. A purple-team test
- D. A blue-team test

**Answer:** A

#### Explanation:

A red-team test is a type of security assessment that simulates a real-world attack on an organization's network, systems, applications, and people. The goal of a red-team test is to evaluate the organization's security posture, identify vulnerabilities and gaps, and test the effectiveness of its detection and response capabilities. A red-team test is usually performed by a group of highly skilled security professionals who act as adversaries and use various tools and techniques to breach the organization's defenses. A red-team test is often conducted without the knowledge or consent of most of the organization's staff, except for a few senior executives who authorize and oversee the exercise.

References: <https://www.comptia.org/certifications/security#examdetails> <https://www.comptia.org/content/guides/comptia-security-sy0-601-exam-objectives>

<https://cybersecurity.att.com/blogs/security-essentials/what-is-red-teaming>

#### NEW QUESTION 248

- (Exam Topic 2)

A company recently enhanced mobile device configuration by implementing a set of security controls: biometrics, context-aware authentication, and full device encryption. Even with these settings in place, an unattended phone was used by a malicious actor to access corporate data.

Which of the following additional controls should be put in place first?

- A. GPS tagging
- B. Remote wipe
- C. Screen lock timer
- D. SEAndroid

**Answer: C**

#### Explanation:

According to NIST Special Publication 1800-4B1, some of the security controls that can be used to protect mobile devices include:

- Root and jailbreak detection: ensures that the security architecture for a mobile device has not been compromised.
- Encryption: protects the data stored on the device and in transit from unauthorized access.
- Authentication: verifies the identity of the user and the device before granting access to enterprise resources.
- Remote wipe: allows the organization to erase the data on the device in case of loss or theft.
- Screen lock timer: sets a time limit for the device to lock itself after a period of inactivity.

#### NEW QUESTION 249

- (Exam Topic 2)

Developers are writing code and merging it into shared repositories several times a day, where it is tested automatically. Which of the following concepts does this best represent?

- A. Functional testing
- B. Stored procedures
- C. Elasticity
- D. Continuous Integration

**Answer: D**

#### Explanation:

Continuous Integration is the concept that best represents developers writing code and merging it into shared repositories several times a day, where it is tested automatically. Continuous Integration is a software development practice that involves integrating code changes from multiple developers into a shared repository frequently and running automated tests to ensure quality and functionality. Continuous Integration can help to detect and fix errors early, improve collaboration, reduce rework, and accelerate delivery. References: <https://www.comptia.org/blog/what-is-devops>

<https://www.certblaster.com/wp-content/uploads/2020/11/CompTIA-Security-SY0-601-Exam-Objectives-1.0.pdf>

#### NEW QUESTION 251

- (Exam Topic 2)

Which of the following is the correct order of evidence from most to least volatile in forensic analysis?

- A. Memory, disk, temporary filesystems, CPU cache
- B. CPU cache, memory, disk, temporary filesystems
- C. CPU cache, memory, temporary filesystems, disk
- D. CPU cache, temporary filesystems, memory, disk

**Answer: C**

#### Explanation:

The correct order of evidence from most to least volatile in forensic analysis is based on how quickly the evidence can be lost or altered if not collected or preserved properly. CPU cache is the most volatile type of evidence because it is stored in a small amount of memory on the processor and can be overwritten or erased very quickly. Memory is the next most volatile type of evidence because it is stored in RAM and can be lost when the system is powered off or rebooted. Temporary filesystems are less volatile than memory because they are stored on disk, but they can still be deleted or overwritten by other processes or users. Disk is the least volatile type of evidence because it is stored on permanent storage devices and can be recovered even after deletion or formatting, unless overwritten by new data. References:

<https://www.comptia.org/blog/what-is-volatility-in-digital-forensics>

#### NEW QUESTION 254

- (Exam Topic 2)

A security administrator recently used an internal CA to issue a certificate to a public application. A user tries to reach the application but receives a message stating, "Your connection is not private." Which of the following is the best way to fix this issue?

- A. Ignore the warning and continue to use the application normally.
- B. Install the certificate on each endpoint that needs to use the application.
- C. Send the new certificate to the users to install on their browsers.
- D. Send a CSR to a known CA and install the signed certificate on the application's server.

**Answer: D**

#### Explanation:

A certificate issued by an internal CA is not trusted by default by external users or applications. Therefore, when a user tries to reach the application that uses an internal CA certificate, they will receive a warning message that their connection is not private<sup>1</sup>. The best way to fix this issue is to use a certificate signed by a well-known public CA that is trusted by most browsers and operating systems<sup>1</sup>. To do this, the security administrator needs to send a certificate signing request (CSR)

to a public CA and install the signed certificate on the application's server<sup>2</sup>. The other options are not recommended or feasible. Ignoring the warning and continuing to use the application normally is insecure and exposes the user to potential man-in-the-middle attacks<sup>3</sup>. Installing the certificate on each endpoint that needs to use the application is impractical and cumbersome, especially if there are many users or devices involved<sup>3</sup>. Sending the new certificate to the users to install on their browsers is also inconvenient and may not work for some browsers or devices<sup>3</sup>.

References: 1:

<https://learn.microsoft.com/en-us/azure/active-directory/develop/howto-create-self-signed-certificate> 2:

<https://learn.microsoft.com/en-us/azure/application-gateway/mutual-authentication-certificate-management> 3: <https://serverfault.com/questions/1106443/should-i-use-a-public-or-a-internal-ca-for-client-certificate-mtls>

#### NEW QUESTION 257

- (Exam Topic 2)

Which of the following processes would most likely help an organization that has conducted an incident response exercise to improve performance and identify challenges?

- A. Lessons learned
- B. Identification
- C. Simulation
- D. Containment

**Answer:** A

#### Explanation:

Lessons learned is a process that would most likely help an organization that has conducted an incident response exercise to improve performance and identify challenges. Lessons learned is a process that involves reviewing and evaluating the incident response exercise to identify what went well, what went wrong, and what can be improved. Lessons learned can help an organization enhance its incident response capabilities, address any gaps or weaknesses, and update its incident response plan accordingly.

References: <https://www.comptia.org/certifications/security#examdetails> <https://www.comptia.org/content/guides/comptia-security-sy0-601-exam-objectives>

<https://www.sans.org/reading-room/whitepapers/incident/incident-handlers-handbook-33901>

#### NEW QUESTION 261

- (Exam Topic 2)

While troubleshooting a firewall configuration, a technician determines that a "deny any" policy should be added to the bottom of the ACL. The technician updates the policy, but the new policy causes several company servers to become unreachable. Which of the following actions would prevent this issue?

- A. Documenting the new policy in a change request and submitting the request to change management
- B. Testing the policy in a non-production environment before enabling the policy in the production network
- C. Disabling any intrusion prevention signatures on the "deny any" policy prior to enabling the new policy
- D. Including an "allow any" policy above the "deny any" policy

**Answer:** B

#### Explanation:

Testing the policy in a non-production environment before enabling the policy in the production network would prevent the issue of making several company servers unreachable. A non-production environment is a replica of the production network that is used for testing, development, or training purposes. By testing the policy in a non-production environment, the technician can verify the functionality and impact of the policy without affecting the real network or users. This can help to identify and resolve any errors or conflicts before applying the policy to the production network. Testing the policy in a non-production environment can also help to ensure compliance with security standards and best practices.

#### NEW QUESTION 265

- (Exam Topic 2)

A security architect is designing the new outbound internet for a small company. The company would like all 50 users to share the same single Internet connection. In addition, users will not be permitted to use social media sites or external email services while at work. Which of the following should be included in this design to satisfy these requirements? (Select TWO).

- A. DLP
- B. MAC filtering
- C. NAT
- D. VPN
- E. Content filter
- F. WAF

**Answer:** CD

#### Explanation:

NAT (Network Address Translation) is a technology that allows multiple devices to share a single IP address, allowing them to access the internet while still maintaining security and privacy. VPN (Virtual Private Network) is a technology that creates a secure, encrypted tunnel between two or more devices, allowing users to access the internet and other network resources securely and privately. Additionally, VPNs can also be used to restrict access to certain websites and services, such as social media sites and external email services.

#### NEW QUESTION 269

- (Exam Topic 2)

An organization recently released a zero-trust policy that will enforce who is able to remotely access certain data. Authenticated users who access the data must have a need to know, depending on their level of permissions.

Which of the following is the first step the organization should take when implementing the policy?

- A. Determine a quality CASB solution.
- B. Configure the DLP policies by user groups.
- C. Implement agentless NAC on boundary devices.
- D. Classify all data on the file servers.

**Answer:** D

**Explanation:**

zero trust is a security strategy that assumes breach and verifies each request as though it originates from an untrusted network<sup>12</sup>. A zero trust policy is a set of “allow rules” that specify conditions for accessing certain resources<sup>3</sup>.

According to one source<sup>4</sup>, the first step in implementing a zero trust policy is to identify and classify all data and assets in the organization. This helps to determine the level of sensitivity and risk associated with each resource and apply appropriate access controls.

Classifying all data on the file servers is the first step in implementing a zero trust policy because it helps to determine the level of sensitivity and risk associated with each resource and apply appropriate access controls.

Reference: Zero Trust implementation guidance | Microsoft Learn

**NEW QUESTION 270**

- (Exam Topic 2)

A security administrator would like to ensure all cloud servers will have software preinstalled for facilitating vulnerability scanning and continuous monitoring. Which of the following concepts should the administrator utilize?

- A. Provisioning
- B. Staging
- C. Development
- D. Quality assurance

**Answer:** A

**Explanation:**

Provisioning is the process of creating and setting up IT infrastructure, and includes the steps required to manage user and system access to various resources . Provisioning can be done for servers, cloud environments, users, networks, services, and more .

In this case, the security administrator wants to ensure that all cloud servers will have software preinstalled for facilitating vulnerability scanning and continuous monitoring. This means that the administrator needs to

provision the cloud servers with the necessary software and configuration before they are deployed or used by customers or end users. Provisioning can help automate and standardize the process of setting up cloud servers and reduce the risk of human errors or inconsistencies.

**NEW QUESTION 273**

- (Exam Topic 2)

A company is auditing the manner in which its European customers' personal information is handled. Which of the following should the company consult?

- A. GDPR
- B. ISO
- C. NIST
- D. PCI DSS

**Answer:** A

**Explanation:**

GDPR stands for General Data Protection Regulation, which is a legal framework that sets guidelines for the collection and processing of personal information of individuals within the European Union (EU). GDPR also applies to organizations outside the EU that offer goods or services to, or monitor the behavior of, EU data subjects. GDPR aims to protect the privacy and rights of EU citizens and residents regarding their personal data. GDPR defines personal data as any information relating to an identified or identifiable natural person, such as name, identification number, location data, online identifiers, or any factors specific to the physical, physiological, genetic, mental, economic, cultural, or social identity of that person. A company that is auditing the manner in which its European customers' personal information is handled should consult GDPR to ensure compliance with its rules and obligations. References:

> <https://www.gdpreu.org/the-regulation/key-concepts/personal-data/>

> <https://ico.org.uk/for-organisations-2/guide-to-data-protection/guide-to-the-general-data-protection-regula>

**NEW QUESTION 276**

- (Exam Topic 2)

A security analyst is reviewing computer logs because a host was compromised by malware After the computer was infected it displayed an error screen and shut down. Which of the following should the analyst review first to determine more information?

- A. Dump file
- B. System log
- C. Web application log
- D. Security too

**Answer:** A

**Explanation:**

A dump file is the first thing that a security analyst should review to determine more information about a compromised device that displayed an error screen and shut down. A dump file is a file that contains a snapshot of the memory contents of a device at the time of a system crash or error. A dump file can help a security analyst analyze the cause and source of the crash or error, as well as identify any malicious code or activity that may have triggered it.

References: <https://www.comptia.org/certifications/security#examdetails> <https://www.comptia.org/content/guides/comptia-security-sy0-601-exam-objectives>

<https://docs.microsoft.com/en-us/windows-hardware/drivers/debugger/introduction-to-crash-dump-files>

**NEW QUESTION 277**

- (Exam Topic 2)

Which of the following best describes the situation where a successfully onboarded employee who is using a fingerprint reader is denied access at the company's main gate?

- A. Crossover error rate
- B. False match raw



- C. False rejection
- D. False positive

**Answer:** C

**Explanation:**

False rejection Short

A false rejection occurs when a biometric system fails to recognize an authorized user and denies access. This can happen due to poor quality of the biometric sample, environmental factors, or system errors. References: <https://www.comptia.org/blog/what-is-biometrics>

**NEW QUESTION 282**

- (Exam Topic 2)

A security administrator is evaluating remote access solutions for employees who are geographically dispersed. Which of the following would provide the MOST secure remote access? (Select TWO).

- A. IPSec
- B. SFTP
- C. SRTP
- D. LDAPS
- E. S/MIME
- F. SSL VPN

**Answer:** AF

**Explanation:**

IPSec (Internet Protocol Security) is a technology that provides secure communication over the internet by encrypting traffic and authenticating it at both the sender and receiver. It can be used to create secure tunnels between two or more devices, allowing users to access resources securely and privately.

SSL VPN (Secure Sockets Layer Virtual Private Network) is a type of VPN that uses an SSL/TLS connection to encrypt traffic between two or more devices. It is a secure and reliable solution for providing remote access, as all traffic is encrypted and authenticated. Additionally, SSL VPNs can also be used to restrict access to certain websites and services, making them a secure and robust solution for remote access.

**NEW QUESTION 283**

- (Exam Topic 2)

A security engineer needs to recommend a solution to defend against malicious actors misusing protocols and being allowed through network defenses. Which of the following will the engineer most likely recommend?

- A. A content filter
- B. A WAF
- C. A next-generation firewall
- D. An IDS

**Answer:** C

**Explanation:**

A next-generation firewall (NGFW) is a solution that can defend against malicious actors misusing protocols and being allowed through network defenses. A NGFW is a type of firewall that can perform deep packet inspection, application-level filtering, intrusion prevention, malware detection, and identity-based access control. A NGFW can also use threat intelligence and behavioral analysis to identify and block malicious traffic based on protocols, signatures, or anomalies.

References:

<https://www.comptia.org/blog/what-is-a-next-generation-firewall>

<https://www.certblaster.com/wp-content/uploads/2020/11/CompTIA-Security-SY0-601-Exam-Objectives-1.0.pdf>

**NEW QUESTION 285**

- (Exam Topic 2)

An organization has expanded its operations by opening a remote office. The new office is fully furnished with office resources to support up to 50 employees working on any given day. Which of the following VPN solutions would best support the new office?

- A. Always-on
- B. Remote access
- C. Site-to-site
- D. Full tunnel

**Answer:** C

**Explanation:**

Site-to-site VPN is a type of VPN solution that connects two or more networks or sites across the public internet in a secure and encrypted way. Site-to-site VPN can be implemented using VPN appliances, such as firewalls or routers, that can establish and maintain the VPN tunnel between the sites. Site-to-site VPN can support multiple users or devices that need to access resources on the other site without requiring individual VPN clients or software. Site-to-site VPN is the best solution to support the new remote office, as it can provide secure and seamless connectivity between the office network and the main network of the organization. Verified References:

➤ Virtual Private Networks – SY0-601 CompTIA Security+ : 3.3 <https://www.professormesser.com/security-plus/sy0-601/sy0-601-video/virtual-private-networks-sy0-601-> (See Site-to-Site VPN)

➤ VPN Technologies – CompTIA Security+ SY0-501 – 3.2 <https://www.professormesser.com/security-plus/sy0-501/vpn-technologies/> (See Site-to-Site VPN)

➤ Security+ (Plus) Certification | CompTIA IT Certifications <https://www.comptia.org/certifications/security> (See Domain 3: Architecture and Design, Objective 3.3: Given a scenario, implement secure network architecture concepts.)

**NEW QUESTION 289**

- (Exam Topic 2)

Which of the following security controls is used to isolate a section of the network and its externally available resources from the internal corporate network in order

to reduce the number of possible attacks?

- A. Faraday cages
- B. Air gap
- C. Vaulting
- D. Proximity readers

**Answer: B**

**Explanation:**

An air gap is a security measure that physically isolates a section of the network from any other network or device that could compromise its security. An air gap prevents any unauthorized access, data leakage, or malware infection through network connections, such as Ethernet cables, wireless signals, or Bluetooth devices. An air gap can be used to protect sensitive or critical systems and data from external threats, such as hackers, spies, or cyberattacks.

**NEW QUESTION 290**

- (Exam Topic 2)

Which of the following models offers third-party-hosted, on-demand computing resources that can be shared with multiple organizations over the internet?

- A. Public cloud
- B. Hybrid cloud
- C. Community cloud
- D. Private cloud

**Answer: A**

**Explanation:**

There are three main models for cloud computing: Infrastructure as a Service (IaaS), Platform as a Service (PaaS), and Software as a Service (SaaS)<sup>12</sup>. Each model represents a different part of the cloud computing stack and provides different levels of control, flexibility, and management.

According to one source<sup>1</sup>, a public cloud is a type of cloud deployment where the cloud resources (such as servers and storage) are owned and operated by a third-party cloud service provider and delivered over the Internet. A public cloud can be shared with multiple organizations or users who pay for the service on a subscription or pay-as-you-go basis.

**NEW QUESTION 294**

- (Exam Topic 2)

An organization's Chief Information Security Officer is creating a position that will be responsible for implementing technical controls to protect data, including ensuring backups are properly maintained Which of the following roles would MOST likely include these responsibilities?

- A. Data protection officer
- B. Data owner
- C. Backup administrator
- D. Data custodian
- E. Internal auditor

**Answer: C**

**Explanation:**

The role that would most likely include the responsibilities of implementing technical controls to protect data and ensuring backups are properly maintained would be a Backup Administrator. A Backup Administrator is responsible for maintaining and managing an organization's backup systems and procedures, which includes ensuring that backups are properly configured, tested and securely stored. They are also responsible for the recovery of data in case of a disaster or data loss.

**NEW QUESTION 296**

- (Exam Topic 2)

A security administrator is integrating several segments onto a single network. One of the segments, which includes legacy devices, presents a significant amount of risk to the network.

Which of the following would allow users to access to the legacy devices without compromising the security of the entire network?

- A. NIDS
- B. MAC filtering
- C. Jump server
- D. IPSec
- E. NAT gateway

**Answer: C**

**Explanation:**

A jump server is a device that acts as an intermediary between users and other devices on a network. A jump server can provide a secure and controlled access point to the legacy devices without exposing them directly to the network. A jump server can also enforce authentication, authorization, logging, and auditing policies.

**NEW QUESTION 299**

- (Exam Topic 2)

An administrator is configuring a firewall rule set for a subnet to only access DHCP, web pages, and SFTP, and to specifically block FTP. Which of the following would BEST accomplish this goal?

- A. [Permission Source Destination Port]Allow: Any Any 80 -Allow: Any Any 443 -Allow: Any Any 67-Allow: Any Any 68 -Allow: Any Any 22 -Deny: Any Any 21 -Deny: Any Any
- B. [Permission Source Destination Port]Allow: Any Any 80 -Allow: Any Any 443 -Allow: Any Any 67-Allow: Any Any 68 -Deny: Any Any 22 -Allow: Any Any 21

-Deny: Any Any

C. [Permission Source Destination Port]Allow: Any Any 80 -Allow: Any Any 443 -Allow: Any Any 22-Deny: Any Any 67 -Deny: Any Any 68 -Deny: Any Any 21

-Allow: Any Any

D. [Permission Source Destination Port]Allow: Any Any 80 -Allow: Any Any 443 -Deny: Any Any 67-Allow: Any Any 68 -Allow: Any Any 22 -Allow: Any Any 21

-Allow: Any Any

**Answer:** A

**Explanation:**

This firewall rule set allows a subnet to only access DHCP, web pages, and SFTP, and specifically blocks FTP by allowing or denying traffic based on the source, destination, and port. The rule set is as follows:

- > Allow any source and any destination on port 80 (HTTP)
- > Allow any source and any destination on port 443 (HTTPS)
- > Allow any source and any destination on port 67 (DHCP server)
- > Allow any source and any destination on port 68 (DHCP client)
- > Allow any source and any destination on port 22 (SFTP)
- > Deny any source and any destination on port 21 (FTP)
- > Deny any source and any destination on any other port

**NEW QUESTION 300**

- (Exam Topic 2)

A security analyst is reviewing packet capture data from a compromised host On the In the packet capture. analyst locates packets that contain large of text, Which Of following is most likely installed on compromised host?

- A. Keylogger
- B. Spyware
- C. Torjan
- D. Ransomware

**Answer:** A

**Explanation:**

A keylogger is a type of malware that records the keystrokes of the user and sends them to a remote attacker. The attacker can use the keystrokes to steal the user's credentials, personal information, or other sensitive data. A keylogger can generate packets that contain large amounts of text, as the packet capture data shows.

**NEW QUESTION 302**

- (Exam Topic 2)

A company needs to enhance Its ability to maintain a scalable cloud Infrastructure. The Infrastructure needs to handle the unpredictable loads on the company's web application. Which of the following cloud concepts would BEST these requirements?

- A. SaaS
- B. VDI
- C. Containers
- D. Microservices

**Answer:** C

**Explanation:**

Containers are a type of virtualization technology that allow applications to run in a secure, isolated environment on a single host. They can be quickly scaled up or down as needed, making them an ideal solution for unpredictable loads. Additionally, containers are designed to be lightweight and portable, so they can easily be moved from one host to another. Reference: CompTIA Security+ Sy0-601 official Text book, page 863.

**NEW QUESTION 304**

- (Exam Topic 2)

A security analyst is investigating a report from a penetration test. During the penetration test, consultants were able to download sensitive data from a back-end server. The back-end server was exposing an API that should have only been available from the company's mobile application. After reviewing the back-end server logs, the security analyst finds the following entries:

```
10.35.45.53 - - [22/May/2020:06:57:31 +0100] "GET /api/cliend_id=1 HTTP/1.1" 403 1705 "http://www.example.com/api/" "PostmanRuntime/7.26.5"
10.35.45.53 - - [22/May/2020:07:00:58 +0100] "GET /api/cliend_id=2 HTTP/1.1" 403 1705 "http://www.example.com/api/" "PostmanRuntime/7.22.0"
10.32.40.13 - - [22/May/2020:08:08:52 +0100] "GET /api/cliend_id=1 HTTP/1.1" 302 21703 "http://www.example.com/api/" "CompanyMobileApp/1.1.1"
10.32.40.25 - - [22/May/2020:08:13:52 +0100] "GET /api/cliend_id=1 HTTP/1.1" 200 21703 "http://www.example.com/api/" "CompanyMobileApp/2.3.1"
10.35.45.53 - - [22/May/2020:08:20:13 +0100] "GET /api/cliend_id=2 HTTP/1.1" 200 22405 "http://www.example.com/api/" "CompanyMobileApp/2.3.0"
```

Which of the following is the most likely cause of the security control bypass?

- A. IP address allow list
- B. User-agent spoofing
- C. WAF bypass
- D. Referrer manipulation

**Answer:** B

**Explanation:**

User-agent spoofing is a technique that involves changing the user-agent string of a web browser or other client to impersonate another browser or device. The user-agent string is a piece of information that identifies the client to the web server and can contain details such as the browser name, version, operating system, and device type. User-agent spoofing can be used to bypass security controls that rely on the user-agent string to determine the legitimacy of a request. In this scenario, the consultants were able to spoof the user-agent string of the company's mobile application and access the API that should have been restricted to it.

#### NEW QUESTION 308

- (Exam Topic 2)

An employee's laptop was stolen last month. This morning, the was returned by the A cyberrsecurity analyst retrieved laptop and has since cybersecurity incident checklist Four incident handlers are responsible for executing the checklist. Which of the following best describes the process for evidence collection assurance?

- A. Time stamp
- B. Chain of custody
- C. Admissibility
- D. Legal hold

**Answer:** B

#### Explanation:

Chain of custody is a process that documents the chronological and logical sequence of custody, control, transfer, analysis, and disposition of materials, including physical or electronic evidence. Chain of custody is important to ensure the integrity and admissibility of evidence in legal proceedings. Chain of custody can help evidence collection assurance by providing proof that the evidence has been handled properly and has not been tampered with or contaminated.

References: <https://www.comptia.org/certifications/security#examdetails> <https://www.comptia.org/content/guides/comptia-security-sy0-601-exam-objectives>  
<https://www.thoughtco.com/chain-of-custody-4589132>

#### NEW QUESTION 312

- (Exam Topic 2)

An annual information security assessment has revealed that several OS-level configurations are not in compliance due to outdated hardening standards the company is using. Which of the following would be best to use to update and reconfigure the OS-level security configurations?

- A. CIS benchmarks
- B. GDPR guidance
- C. Regional regulations
- D. ISO 27001 standards

**Answer:** A

#### Explanation:

CIS benchmarks are best practices and standards for securing various operating systems, applications, cloud environments, etc. They are developed by a community of experts and updated regularly to reflect the latest threats and vulnerabilities. They can be used to update and reconfigure the OS-level security configurations to ensure compliance and reduce risks.

#### NEW QUESTION 314

- (Exam Topic 2)

Which Of the following control types is patch management classified under?

- A. Deterrent
- B. Physical
- C. Corrective
- D. Detective

**Answer:** C

#### Explanation:

Patch management is a process that involves applying updates or fixes to software to address bugs, vulnerabilities, or performance issues. Patch management is classified under corrective control type, which is a type of control that aims to restore normal operations after an incident or event has occurred. Corrective controls can help mitigate the impact or damage caused by an incident or event and prevent it from happening again.

References: <https://www.comptia.org/certifications/security#examdetails> <https://www.comptia.org/content/guides/comptia-security-sy0-601-exam-objectives>  
<https://www.csoonline.com/article/2124681/why-third-party-security-is-your-security.html>

#### NEW QUESTION 317

- (Exam Topic 2)

Two organizations are discussing a possible merger Both Organizations Chief Fi-nancial Officers would like to safely share payroll data with each Other to de- termine if the pay scales for different roles are similar at both organizations Which Of the following techniques would be best to protect employee data while allowing the companies to successfully share this information?

- A. Pseudo-anonymization
- B. Tokenization
- C. Data masking
- D. Encryption

**Answer:** A

#### Explanation:

Pseudo-anonymization is a technique of replacing sensitive data with artificial identifiers or pseudonyms that preserve some characteristics or attributes of the original data. It can protect employee data while allowing the companies to successfully share this information by removing direct identifiers such as names, addresses, etc., but retaining indirect identifiers such as job roles, pay scales, etc., that are relevant for the comparison.

#### NEW QUESTION 319

.....



## THANKS FOR TRYING THE DEMO OF OUR PRODUCT

Visit Our Site to Purchase the Full Set of Actual SY0-701 Exam Questions With Answers.

We Also Provide Practice Exam Software That Simulates Real Exam Environment And Has Many Self-Assessment Features. Order the SY0-701 Product From:

<https://www.2passeasy.com/dumps/SY0-701/>

## Money Back Guarantee

### **SY0-701 Practice Exam Features:**

- \* SY0-701 Questions and Answers Updated Frequently
- \* SY0-701 Practice Questions Verified by Expert Senior Certified Staff
- \* SY0-701 Most Realistic Questions that Guarantee you a Pass on Your FirstTry
- \* SY0-701 Practice Test Questions in Multiple Choice Formats and Updatesfor 1 Year